

Request for Proposals  
for the  
Signage Project, Phase 1  
BALBOA PARK  
SAN DIEGO, CALIFORNIA

Forever Balboa Park  
1549 El Prado, Balboa Park  
San Diego, CA 92101

May 26, 2023

Request for Proposals  
Signage Project, Phase 1  
SAN DIEGO, CALIFORNIA

The following Request for Proposals outlines an opportunity to participate in an important Signage & Wayfinding project to improve the visitor experience in Balboa Park, San Diego, CA. Forever Balboa Park, the contracting non-profit organization, is inviting proposals for the enclosed Scope of Work, to be submitted before 5pm on ~~Tuesday, June 20~~, Friday, July 7, 2023 to Forever Balboa Park, 1549 El Prado, Suite 1, (Attn: Brigitta Rehn), Balboa Park, San Diego, CA 92101 or [brigitta@balboapark.org](mailto:brigitta@balboapark.org). Forever Balboa Park, reserves the right to reject any or all bids, to waive technical errors, discrepancies or informalities of a bid not affected by law.

INSTRUCTIONS TO BIDDERS

Proposals: To receive consideration, proposals shall be made in accordance with the following instructions:

- A. Bidders shall examine all the bid documents, including all drawings, exhibits, and maps, and perform their own estimates for the proposed work, taking into account local conditions, uncertainty of weather, and all laws, ordinances, rules and regulations of any federal, state, county, municipal or other governmental agency that has jurisdiction over the work.
- B. Bids shall be emailed to Brigitta Rehn at [brigitta@balboapark.org](mailto:brigitta@balboapark.org) in PDF format clearly marked "Bid Proposal" on or before the scheduled time for receipt of bids in the published Advertisement for Bids.
- D. DO NOT CONTACT THE DESIGN CONSULTANT. All technical questions are to be submitted in writing to the attention of Brigitta Rehn ([brigitta@balboapark.org](mailto:brigitta@balboapark.org)) by 5pm on Wednesday, June 7th.

Withdrawal of Bids: Any bidder may withdraw their bid, personally or by written request, at any time prior to the scheduled time for receipt of bids. No bid may be withdrawn after the scheduled bid opening, or within sixty (60) days thereafter.

Opening of Bids: Bids will be opened and evaluated by ~~June 29, 2023~~ July 14, 2023

## Project Description

PROJECT: Signage Phase 1, Balboa Park

LOCATION: Balboa Park, San Diego, CA 92101

CLIENT: Forever Balboa Park

PROPOSALS DUE: ~~Tuesday, June 20, 2023~~ Friday, July 7 @ 5:00 pm

### **About Forever Balboa Park**

In July 2021, the Balboa Park Conservancy and Friends of Balboa Park merged to form [Forever Balboa Park](#) (FBP). The merger of two long-time Balboa Park advocacy and park improvement organizations was transformational, representing a turning point for Balboa Park. By combining resources, the new organization is better positioned to support the diverse needs of the park and strengthen its partnership with the City of San Diego, thereby increasing the organization's ability to make improvements to the park. Helping to fill the gap between what the City of San Diego can provide for Balboa Park and what it needs to become a world-class park resource, FBP plans and implements park improvement projects, manages a parkwide volunteer corps of 350+, helps care for the park's urban forest, and enhances the visitor experience through a historic carousel and visitor center that collectively serve more than 700,000 visitors annually.

### **Project History**

From 2017-2019, Forever Balboa Park and its contractor, RSM Design, engaged community stakeholders to explore how to improve park visitors' experience through enhanced wayfinding and signage. This engagement process yielded a new signage manual for Balboa Park, which was approved by the City's Balboa Park Committee in October 2019. This Balboa Park Sign Manual can be found at <https://www.sandiego.gov/sites/default/files/bpsignmanualupdate.pdf>

### **Project Description**

Forever Balboa Park, the leading nonprofit organization partnering with the city and other community organizations to enhance the park, has committed to advancing a first phase of wayfinding and signage improvement in alignment with the new sign manual. Designs have already been completed, and Phase 1 consists of the fabrication and installation of 38 signs in six different sign types. Fifteen of the signs will simply be refurbished and repainted according to the new sign parameters, and 23 will be newly fabricated for this project.

### **Known Parameters:**

1. Location of signs: Within Balboa Park's 1200 acres at specifically identified locations.  
(See map for sign locations: [Signage & Wayfinding Phase 1 Locations](#))

2. Design of signs, including layout, colors, and fonts: specifications contained in the approved [Balboa Park Sign Manual](#) (See attached)
3. Content and language of specific signs: specifications approved and will be available to the selected contractor

### **Scope of Work**

1. Preparation, submittal, and revision (as needed) of detailed shop drawings for each of the 38 signs
  - a. Shop drawings shall include plan for discrete and Sign Manual aligned sign attachment methods
  - b. Shop drawings shall detail base attachment and footing
  - c. Shop drawings shall include structural calculations for all sign and pole attachments
2. Removal and repainting of 15 existing signs
3. Fabrication of 23 new signs
4. Removal of 8 existing poles not to be re-used in this phase.
5. Acquisition and installation of 28 new poles (note: some signs require 2 poles)
6. Preparation and repainting of 16 existing poles (pole preparation and repainting may occur on-site or at contractor's shop; note in proposal which is the anticipated method)
7. Installation of 38 signs in Balboa Park including providing all needed footings and hardware per approved shop drawings.
8. Submitting for and securing a permit from the City of San Diego Development Services Department for installation of 8 signs located within public right-of-way. (Forever Balboa Park has the right of entry permit for installation in the other required locations.)

### **Desired timeline**

(Note in the response to the proposal bid documents whether your anticipated timeline would differ from these parameters shown below and include rationale.)

- May 26, 2023 - Publication of RFP
- June 7, 2023 - Submittal of any/all RFP questions (in writing) to FBP
- June 12, 2023 - FBP written response to all submitted questions
- ~~June 20, 2023~~ July 7, 2023 - Proposals due 5pm PST
- ~~June 30, 2023~~ July 14, 2023 - Notification of selected contractor
- Sept 15, 2023 - Submission of shop drawings
- October 20, 2023 - Parks and Recreation approval of shop drawings
- October 31, 2023 - Revisions of shop drawing due
- November 7, 2023 - FBP approval of revised drawings
- January 10, 2024 - Fabrication of signs completed
- March 1, 2024 - Sign installation completed. Note: please provide details re. your recommendation of sequencing and batching fabrication and installation
- April 1, 2024 - Final signage walkthrough and final project documentation



In compliance with FBP's invitation for bids, the undersigned has carefully examined the project Bid Documents, including the drawings and specifications, for the scope of work which is all work associated with the project and fully understands the scope and meaning of the Bid Documents.

The undersigned hereby agrees to furnish all deliverables, materials, labor, tools, equipment, apparatus, facilities, and transportation necessary to complete all work in strict conformity with the drawings and specifications.

### **Proposal Elements**

Proposals are required to include the scope for the entire work. Please include in your bid a breakdown of proposed costs in the following categories, as well as a total proposed project cost:

1. Labor and Materials Costs for Fabrication of New Signs
2. Labor and Materials Costs for Posts
3. Labor and Materials Costs for Repainting of Existing Signs
4. Labor and Materials Costs for Installation of Signs
5. Labor Costs for Shop Drawings
6. Mobilization
7. Site Surveying
8. Project Management
9. Other

The proposal should include applicable California state sales tax, bonds, insurance and all other costs required to perform all the work described in the project drawings and specifications.

### **Time of Completion**

Please provide a detailed schedule for proposal completion, taking into account the broad parameters for the project provided on page 3. Please ensure the project schedule includes, at a minimum, the following proposed dates:

1. The proposed date for completion of shop drawings.
2. The time required for completion of sign fabrication.
3. The time required for installation of signs.
4. The proposed date of substantial completion.
5. The proposed date of final completion.

**Relevant Experience**

Please provide a summary and any relevant examples, including images if available, of similar projects you have undertaken in the past. Contractor must be able to show successful completion of at least 2 projects of similar scope and scale regarding quantity, quality, and sign fabrication and installation. Contractor may include what interests you about this project, and any particular experience you have had working in Balboa Park or other public parks on wayfinding related projects and any other details you think will help us understand your interest and experience.

**Rejection of Bids**

The undersigned agrees that Forever Balboa Park reserves the right to reject any or all bids, and reserves the right to waive informalities in a bid or bids, not affected by law, if to do so seems to best serve the interest of Forever Balboa Park.

**Validity of Bids**

The undersigned agrees that this bid will remain valid for sixty (60) days after the scheduled bid opening.

**State Licenses**

The undersigned hereby certifies that they currently hold any and all relevant licenses required by the State of California and The City of San Diego and that the license(s) is(are) the correct class of license for the work described in the project drawings and specifications.

**City Requirements**

Requirements for Public Works Contracts, including small and local business program requirements, are in Municipal Code (Section 22.3101 and 22.3601), competitive bidding procedures are in City Charter (Section 94) and in Municipal Code (Sections 22.3106, 22.3107, and 22.3108). A listing of several other provisions are included in the list below.

The General Terms & Provisions template require Contractors to comply with City-mandated clauses throughout the duration of the Contract:

- Drug-Free Workplace Certification (Council Policy 100-17)
- Americans with Disabilities Act and State Access Laws and Regulations (Council Policy 100-04)
- Equal Opportunity Contracting (SDMC § 22.2704)
- Non-Discrimination (SDMC § 22.3512)
- Compliance Investigation (SDMC § 22.3514)
- Equal Benefits Ordinance (SDMC §§ 22.4301 through 22.4308)
- Living Wages (SDMC §§ 22.4201 through 22.4245)
- Prevailing Wages (SDMC § 22.3019)
- Contractor Standards (SDMC § 22.3004(a))
- Noise Abatement (SDMC § 59.5.0301)

- Service Worker Retention (SDMC §§22.2801 through 22.2806)
- Product Endorsement (Council Policy 000-41)
- Business Tax Certificate (SDMC §31.0121, SDMC §31.0142)
- Equal Pay went into effect as of January 1, 2018

### **Other Conditions**

1. Work Days/Hours: Monday through Friday, 6:30 am to 5:30 pm
2. Staging Area(s): TBD and as needed by sign location. To be coordinated with the Parks & Recreation Dept and Forever Balboa Park.
3. COVID-19: The contractor must abide by all State of California and County of San Diego COVID-19 worker safety requirements.
4. Progress Meetings: Regular progress meetings, at least twice per month, must be facilitated by the contractor. Meeting minutes and action items to be written by the contractor.

### **Insurance**

The undersigned agrees to furnish certified copies of all insurance policies and endorsements; all certificates of comprehensive, general and auto liability insurance; Workers' Compensation insurance; and such other insurance that will protect them from claims for damages and personal injury, including death, which may arise from operations under the contract, whether such operation be by the undersigned or by any subcontractor of the undersigned, or anyone directly or indirectly employed by the undersigned or any subcontractor of the undersigned. The certified copies, certificates and additional endorsements, will be filed at the time of execution of the contract. All policies (excluding Workers' Compensation) shall name Forever Balboa Park as an additional named insured. All coverages shall be subject to approval by Forever Balboa Park for adequacy of protection.

### **Inaccuracies or Misrepresentations**

If during the course of the administration of this agreement Forever Balboa Park determines that the contractor has made a material misstatement or misrepresentation or that materially inaccurate information has been provided to Forever Balboa Park, this contract may be immediately terminated. If this contract is terminated according to this provision, Forever Balboa Park is entitled to pursue any available legal remedies.

### **Designation of Subcontractors**

In compliance with the provisions of Section 4100-4108 of the Public Contract Code of the State of California, and any amendments thereof, the undersigned shall set forth below the name and street address of the mill, shop or office of each subcontractor who will perform work or labor, or render services to the Contractor in an amount greater than one-half of one percent (1/2 of 1%) of the total bid; and, the general category or the portion of the work to be performed by each subcontractor.

**Subcontractor Portion of Work****Location****Phone No.**

(Description of work to be performed)

[Insert here as relevant]

**Non-Collusion Affidavit–Principal Contractor**

The undersigned has submitted with the bid proposal a notarized non-collusion affidavit for the principal contractor. The undersigned agrees to furnish Forever Balboa Park notarized non-collusion affidavits for subcontractors, and states that this is a genuine proposal and is neither collusive nor made in the interest of any other person, and has not induced anyone to submit a sham bid or refrain from bidding.

The undersigned declares that the only person or parties interested in this proposal as principals are those named herein; that this bid is made without any connection with any other person or persons making a bid for the same work, except for another division of the undersigned which may submit an independent bid; that the bid is in all respects fair and without collusion or fraud; that the undersigned has read the Advertisement for Bids and the Instructions to Bidders, and plans and specifications package and agrees to all the stipulations contained therein; that the undersigned has examined the form of contract (including the specifications, drawings, and other documents incorporated therein by reference); that in the event this bid as submitted, including the incorporated bidding documents, be accepted by Forever Balboa Park, the undersigned shall execute a contract to perform the work as outlined herein.

If undersigned is a corporation, the proposal must be signed by an authorized officer of the corporation. This Bid Proposal must be accompanied by a document evidencing such officer is authorized to sign. Check One:

- ☐ Sole Proprietor  
☐ Partnership  
☐ Corporation  
☐ Other

Name of Bidder: \_\_\_\_\_

Address: \_\_\_\_\_

\_\_\_\_\_  
Phone: \_\_\_\_\_

Relevant License No.: \_\_\_\_\_ Primary Class: \_\_\_\_\_

Expiration Date of License \_\_\_\_\_

Social Security No. or Federal Employer ID No.: \_\_\_\_\_

I declare under penalty of perjury the above is true and correct.

Authorized Signature: \_\_\_\_\_ Title: \_\_\_\_\_

Print Name: \_\_\_\_\_ Date: \_\_\_\_\_

**Appendix A:**

Please refer to the Balboa Park Phase I Signage and Wayfinding Project Exhibits, which is provided along with this Proposal.





SIGNAGE AND WAYFINDING

PHASE 1 EXHIBITS

SPRING 2023







# TABLE OF CONTENTS

01 PHASE I SIGN TYPES

Sign Schedule ----- 4

A1 - Tram Stop (Pole Mounted) ----- 6

A3 - Auto Traffic Directional ----- 8

A4 - Pedestrian Orientation ----- 10

A5 - Pedestrian Directional ----- 12

A6 - High Speed Vehicular Directional ----- 14

A13 - Balboa Park Identity ----- 16

02 ADDITIONAL GUIDELINES

Pole Standards ----- 18

Attachment Details ----- 23

Paint and Materials ----- 25

Sign Locations Map -----26

rsmdesign

160 Cabrillo  
San Clemente  
CA 2672  
949.492.9479

rsmdesign.com

PACKAGE NOTES  
All drawings and written materials appearing herein constitute original and unpublished work of RSM Design Inc. and may not be used or disclosed without written consent of RSM Design Inc.

All drawings must comply with specifications noted at the beginning of this package.

PLEASE NOTE  
All images used within this document are for internal use only. RSM Design does not have the copyrights for the various images used and therefore are not to be published or shared.

PROJECT : Balboa Park  
PACKAGE: Design Development

REVISIONS:                      DATE:



01



PHASE ONE  
SIGN TYPES

rsmdesign

160 Cabrillo  
San Clemente  
CA 2672  
949.492.9479

rsmdesign.com

PACKAGE NOTES  
All drawings and written  
materials appearing herein  
constitute original and  
unpublished work of RSM Design  
Inc. and may not be used or  
disclosed without written  
consent of RSM Design Inc.

All drawings must comply  
with specifications noted at the  
beginning of this package.

PLEASE NOTE  
All images used within this  
document are for internal  
use only. RSM Design does  
not have the copyrights for  
the various images used and  
therefore are not to be  
published or shared.

PROJECT : Balboa Park  
PACKAGE: Design Development

REVISIONS:                      DATE:



SIGN SCHEDULE

SCHEDULE 01 OF 01

Please note all quantities and locations will need to finalized by client and field verified by sign fabricator prior to installation.

SIGN ID	SIGN TYPE	TOTAL QTY	EXISTING	NEW	EXISTING POLES	NEW POLES	COMMENTS/NOTES
A1	Tram Stop (Pole Mounted)	5	0	5	3	2	1 existing pole to be repainted
A3	Auto Traffic Directional	14	9	5	10	4	Existing signs and poles to be repainted. 2 double-sided signs.
A4	Pedestrian Orientation	5	3	2	6	4	Existing signs and poles to be repainted; 2 poles per sign
A5	Pedestrian Directional	5	3	2	0	5	Existing signs to be repainted. All signs double-sided.
A6	High Speed Directional	4	0	4	0	8	New signs along primary arteries throughout the park; 2 poles per sign
A13	Balboa Park Identity	5	0	5	0	5	New signs mounted to existing lightpoles or new poles with below grade foundation
Totals		38	15	23	19	28	

POLE TYPE	TOTAL QTY	EXISTING	NEW	Catalog #	COMMENTS/NOTES
Mariner 14' height	12	9	3	APSM RN-18-14.00-S45-CU	
Mini-Mariner 12' height	6		6	APSMNM-12-12.00-S30-CU	
Mini-Mariner 10' height	2	1	1	APSMNM-12-10.00-S30-CU	
Mini-Mariner 7' height	16	6	10	APSMNM-12-07.00-S30-CU	For 8 signs (2 Mini-Mariner 7' height poles per sign)
Capistrano 12'-6" height	6		6	APSCPS-19-12.50-2F-TN2.88/2.00-CU	
Capistrano 7' height	2		2	APSCPS-19-12.50-2F-TN2 .88/2 .00-CU	For 1 sign (2 Capistrano 7' height poles per sign)
Other	3	3			These poles will not be repainted

GENERAL PACKAGE NOTES:

1. All signs, structures and letters need to be engineered by sign fabricator prior to shop drawing submittal and fabrication for structural and backing requirements to withstand local regulations, codes and weather conditions.
2. All sizes shown are approximate and should be verified prior to final fabrication based on as built conditions on site, fabricator to notify team if difference occurs per as built conditions.
3. Fabricator must use Matthews UV clear coat on painted surfaces to minimize / prevent as much as possible any noticeable fading.
4. All metal edges to be eased; corners to have a maximum radius of .0125. All welds to be ground smooth prior to final painting and clear coated / vandalism coating are applied.
5. No exposed fasteners unless noted within the design intent drawing or approved in shop drawing. Fasteners throughout package to be tamper proof, fabricator to submit sample for approval prior to ordering.
6. All integrated signages to be coordinated with Client prior to final fabrication and installation.
7. Fabricator to calculate all sign weight loads to be provided to general contractor for additional backing that may be required.
8. Fabricator to provide power requirement for each sign type prior to shop drawings submittal to Client.
9. All existing conditions to be field verified by fabricator prior to shop drawings are generated to ensure that all as built conditions are accommodated. Including all unknowns such as hardscape elevations / conditions and mounting details to support all sign types.
10. All messaging within this package is placeholder at this time until written approval is received by the client team prior to fabrication.
11. The Balboa Park Sign Manual Dated October 3rd, 2019 is the City approved guiding manual for all Balboa Park Signs. Unless amended in writing with client approval this manual is the primary source to dictate any design, layout, hierarchy, color, font, icon, arrow, material, fasteners mounting, etc. questions and discrepancies.

MOCK-UPS

All signs shall be provided as Full Size, 3M Full color digital print mock-ups by fabricator prior to fabrication.



rsmdesign

160 Cabrillo  
San Clemente  
CA 92672  
949.492.9479

rsmdesign.com

PACKAGE NOTES  
All drawings and written materials appearing herein constitute original and unpublished work of RSM Design Inc. and may not be used or disclosed without written consent of RSM Design Inc.

All drawings must comply with specifications noted at the beginning of this package.

PLEASE NOTE  
All images used within this document are for internal use only. RSM Design does not have the copyrights for the various images used and therefore are not to be published or shared.

PROJECT : Balboa Park  
PACKAGE: Design Development

REVISIONS:      DATE:

# SIGN TYPES (PHASE 1)

Please note all quantities and locations will need to be finalized by client and field verified by sign fabricator prior to installation. Listed here are to apply to all sign types within this package unless otherwise noted on the individual design drawing. Sign fabricator to confirm all final sign messaging and locations with client or general contractor prior to fabrication.



rsmdesign

160 Cabrillo  
San Clemente  
CA 2672  
949.492.9479

rsmdesign.com

**PACKAGE NOTES**  
All drawings and written materials appearing herein constitute original and unpublished work of RSM Design Inc. and may not be used or disclosed without written consent of RSM Design Inc.

All drawings must comply with specifications noted at the beginning of this package.

**PLEASE NOTE**  
All images used within this document are for internal use only. RSM Design does not have the copyrights for the various images used and therefore are not to be published or shared.

PROJECT : Balboa Park  
PACKAGE: Design Development

REVISIONS:      DATE:

REFER TO GENERAL PACKAGE NOTES ON PAGE 11.

DRAWING FOR DESIGN INTENT ONLY; NOT INTENDED FOR CONSTRUCTION.  
ALL SIGNS TO BE FABRICATED & INSTALLED PER APPROVED FABRICATOR SHOP DRAWINGS.  
Updated 6/29/2023

SIGNTYPE

# A1 - TRAM STOP IDENTITY



**GENERAL NOTES**  
All copy and messaging currently shown at this time is placeholder only and is to be provided by the client team prior to fabrication.

All final quantities and locations are to be field verified by fabricator and approved by client team prior to fabrication.

Fabricator must supply shop drawings and specifications for approval. Casted items must be painted with three (3) coats of polyurethane.

Aluminum can signs to be tack welded and filled with bondo. All surfaces to be sanded smooth free of voids, warping or canning. Then sprayed with 3 coats: 1 coat of filler primer, sand, 1 color coat of sealer primer, sand, and 1 color coat of polyurethane, gloss finish.

Single-sided sign blanks to have smooth edges and surfaces. Paint all surfaces with 3 color coats of polyurethane, gloss finish.

The sign and pole primer is Calspar Val-Chem Epoxy Primer (13-F-62). The color coating is Valspar V Thane Hi Solids Urethane Enamel (54 series), color to match MP20189 Corinthian Bronze Metallic.

The casted brackets, sign pipes and connections must be engineered for sheer stress and vertical weight prior to fabrication and installation. The signs must meet current sign codes for the City of San Diego and The Balboa Park Sign Manual (Oct. 2019).

Use only stainless steel fasteners on signs and supports

All graphics to be premium grade computer cut white vinyl.



rsmdesign

160 Cabrillo  
San Clemente  
CA 2672  
949.492.9479

rsmdesign.com

**PACKAGE NOTES**  
All drawings and written materials appearing herein constitute original and unpublished work of RSM Design Inc. and may not be used or disclosed without written consent of RSM Design Inc.

All drawings must comply with specifications noted at the beginning of this package.

**PLEASE NOTE**  
All images used within this document are for internal use only. RSM Design does not have the copyrights for the various images used and therefore are not to be published or shared.

PROJECT : Balboa Park  
PACKAGE: Design Development

REVISIONS:      DATE:



SIGNTYPE

# A1 - TRAM STOP IDENTITY

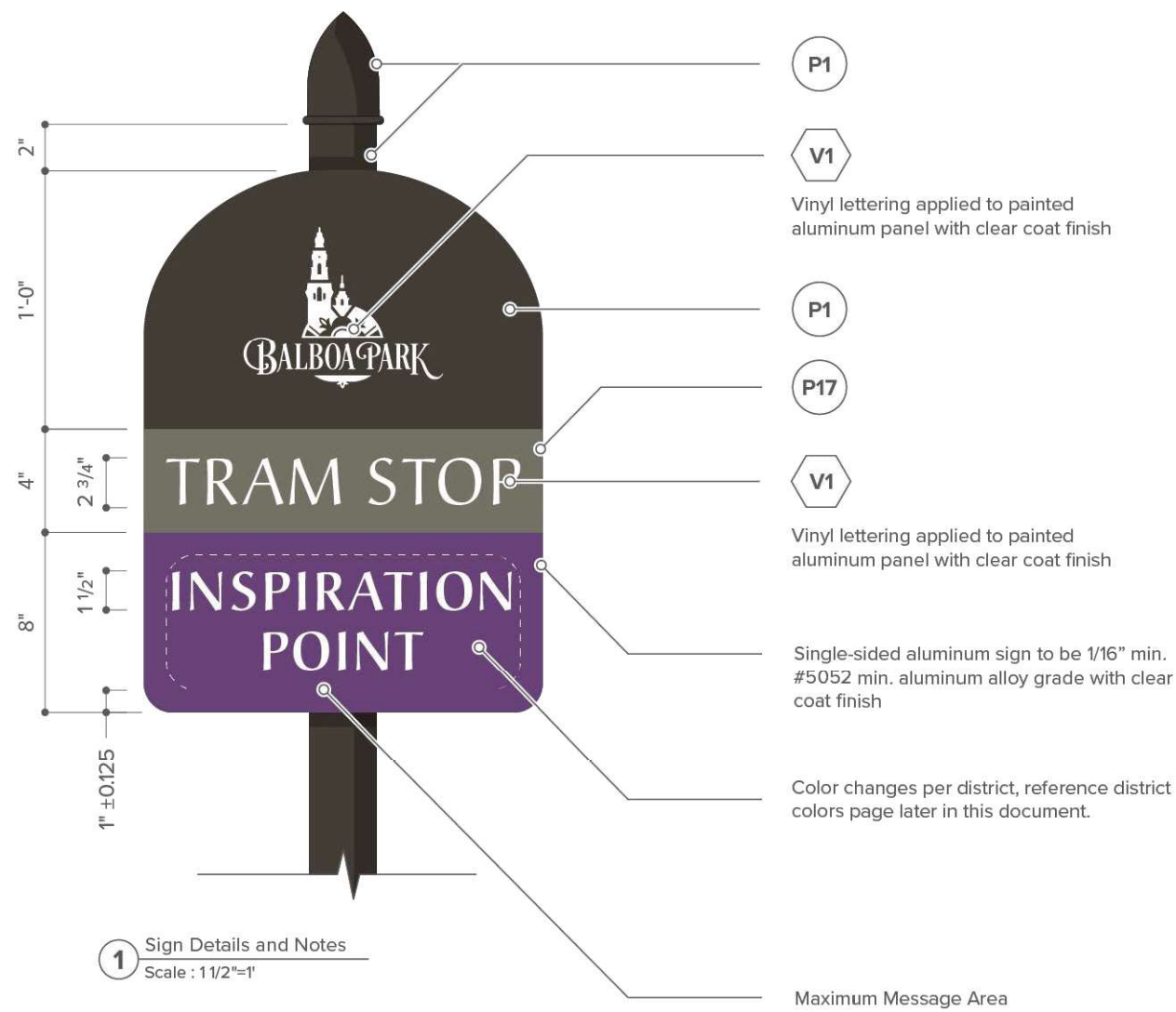

rsmdesign

160 Cabrillo  
San Clemente  
CA 2672  
949.492.9479

rsmdesign.com

**PACKAGE NOTES**  
All drawings and written materials appearing herein constitute original and unpublished work of RSM Design Inc. and may not be used or disclosed without written consent of RSM Design Inc.

All drawings must comply with specifications noted at the beginning of this package.

**PLEASE NOTE**  
All images used within this document are for internal use only. RSM Design does not have the copyrights for the various images used and therefore are not to be published or shared.

PROJECT : Balboa Park  
PACKAGE: Design Development

REVISIONS:      DATE:

SIGNTYPE

# A3 AUTO TRAFFIC DIRECTIONAL



rsmdesign

160 Cabrillo  
San Clemente  
CA 2672  
949.492.9479

rsmdesign.com

**PACKAGE NOTES**  
All drawings and written materials appearing herein constitute original and unpublished work of RSM Design Inc. and may not be used or disclosed without written consent of RSM Design Inc.

All drawings must comply with specifications noted at the beginning of this package.

**PLEASE NOTE**  
All images used within this document are for internal use only. RSM Design does not have the copyrights for the various images used and therefore are not to be published or shared.

PROJECT : Balboa Park  
PACKAGE: Design Development

REVISIONS:      DATE:

SIGNTYPE

A3 - AUTO TRAFFIC DIRECTIONAL

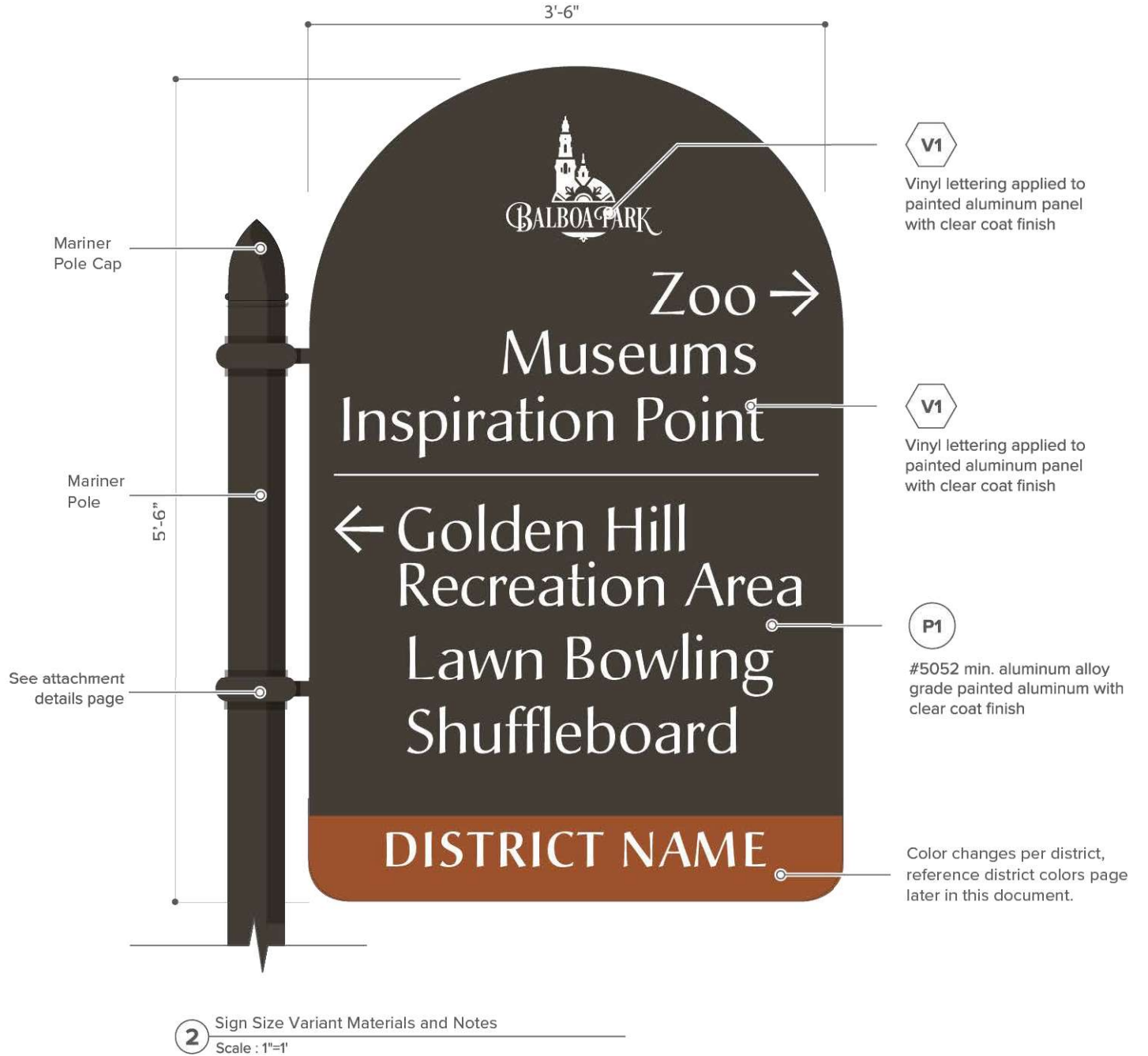
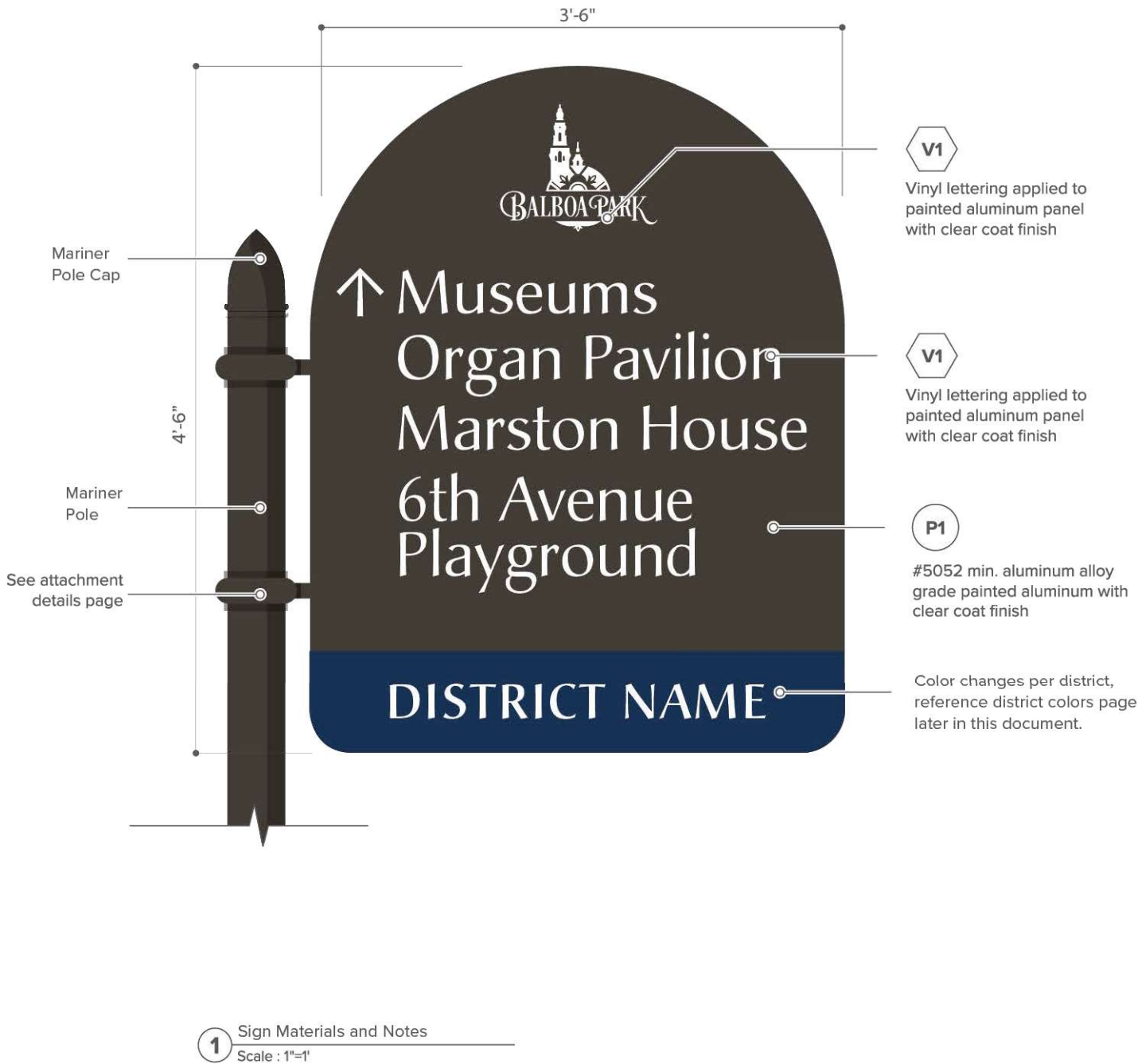

rsmdesign

160 Cabrillo  
San Clemente  
CA 2672  
949.492.9479

rsmdesign.com

PACKAGE NOTES  
All drawings and written materials appearing herein constitute original and unpublished work of RSM Design Inc. and may not be used or disclosed without written consent of RSM Design Inc.

All drawings must comply with specifications noted at the beginning of this package.

PLEASE NOTE  
All images used within this document are for internal use only. RSM Design does not have the copyrights for the various images used and therefore are not to be published or shared.

PROJECT : Balboa Park  
PACKAGE: Design Development

REVISIONS: DATE:

Sign to be 3 " thick and manufactured of painted aluminum with a 60° arch top and 1 -1/2 " radius bottom corners.

SIGNTYPE

# A4 - PEDESTRIAN ORIENTATION



1 Mini Mariner Pole Dimensions  
Scale : 1/2"=1'

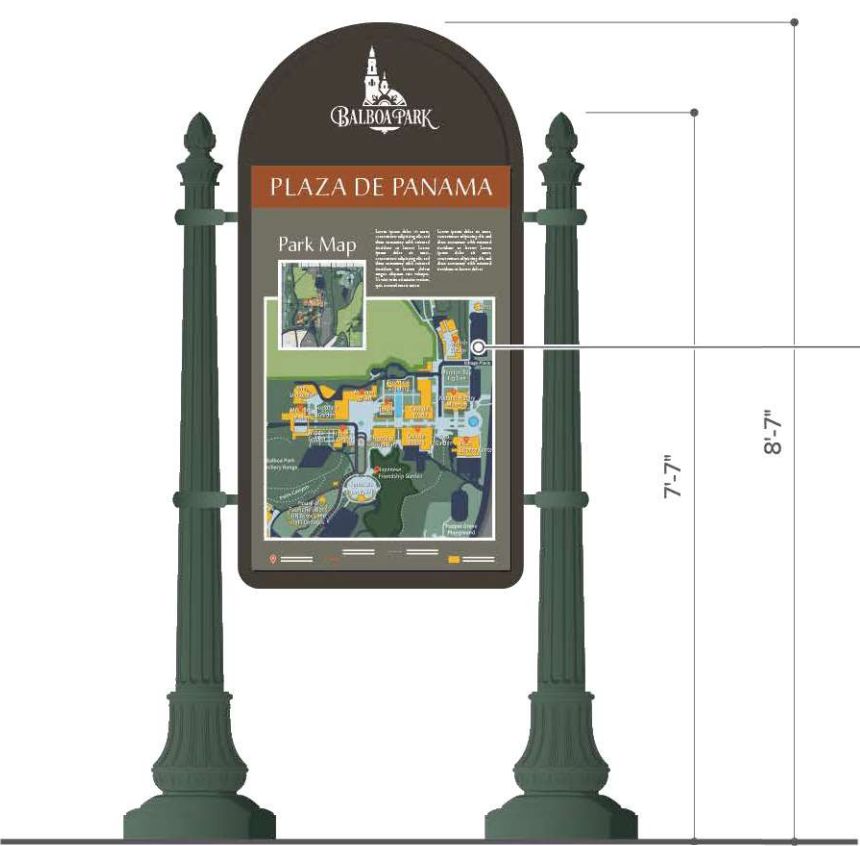

2 Capistrano Pole Dimensions  
Scale : 1/2"=1'

**PLEASE NOTE**  
The sign is two sided and will have the same messaging on front and back of directory panel. Final Directory Map TBD

**rsmdesign**  
160 Cabrillo  
San Clemente  
CA 2672  
949.492.9479  
rsmdesign.com

**PACKAGE NOTES**  
All drawings and written materials appearing herein constitute original and unpublished work of RSM Design Inc. and may not be used or disclosed without written consent of RSM Design Inc.

All drawings must comply with specifications noted at the beginning of this package.

**PLEASE NOTE**  
All images used within this document are for internal use only. RSM Design does not have the copyrights for the various images used and therefore are not to be published or shared.

PROJECT : Balboa Park  
PACKAGE: Design Development

REVISIONS:      DATE:



SIGNTYPE

# A4 - PEDESTRIAN ORIENTATION



rsmdesign

160 Cabrillo  
San Clemente  
CA 92672  
949.492.9479

rsmdesign.com

**PACKAGE NOTES**  
All drawings and written materials appearing herein constitute original and unpublished work of RSM Design Inc. and may not be used or disclosed without written consent of RSM Design Inc.

All drawings must comply with specifications noted at the beginning of this package.

**PLEASE NOTE**  
All images used within this document are for internal use only. RSM Design does not have the copyrights for the various images used and therefore are not to be published or shared.

PROJECT : Balboa Park  
PACKAGE: Design Development

REVISIONS:      DATE:

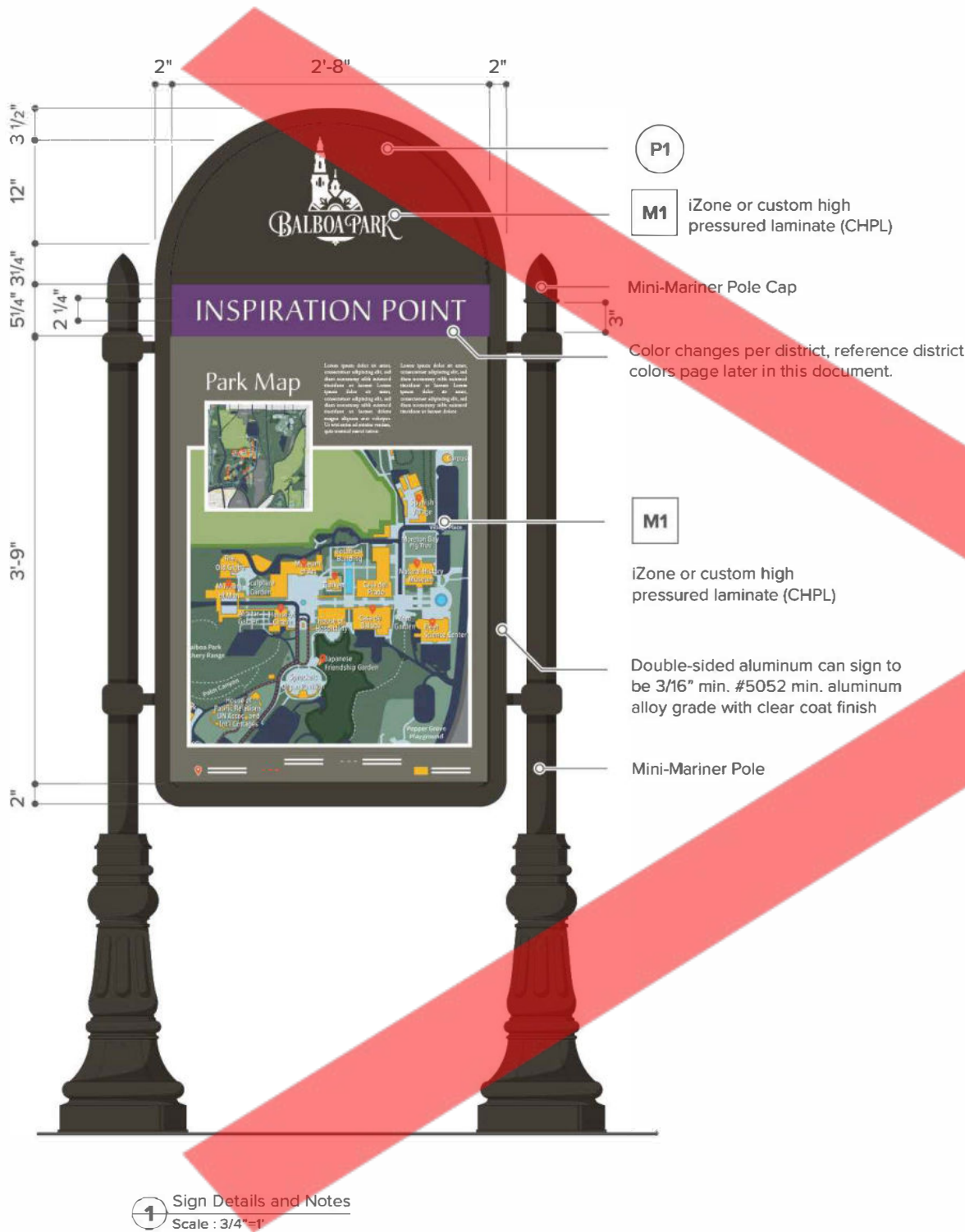

1 Sign Details and Notes  
Scale : 3/4"=1'

Sign to be 3 " thick and manufactured of painted aluminum with a 60° arch top and 1 -1/2 " radius bottom corners.



SIGNTYPE

# A4 - PEDESTRIAN ORIENTATION

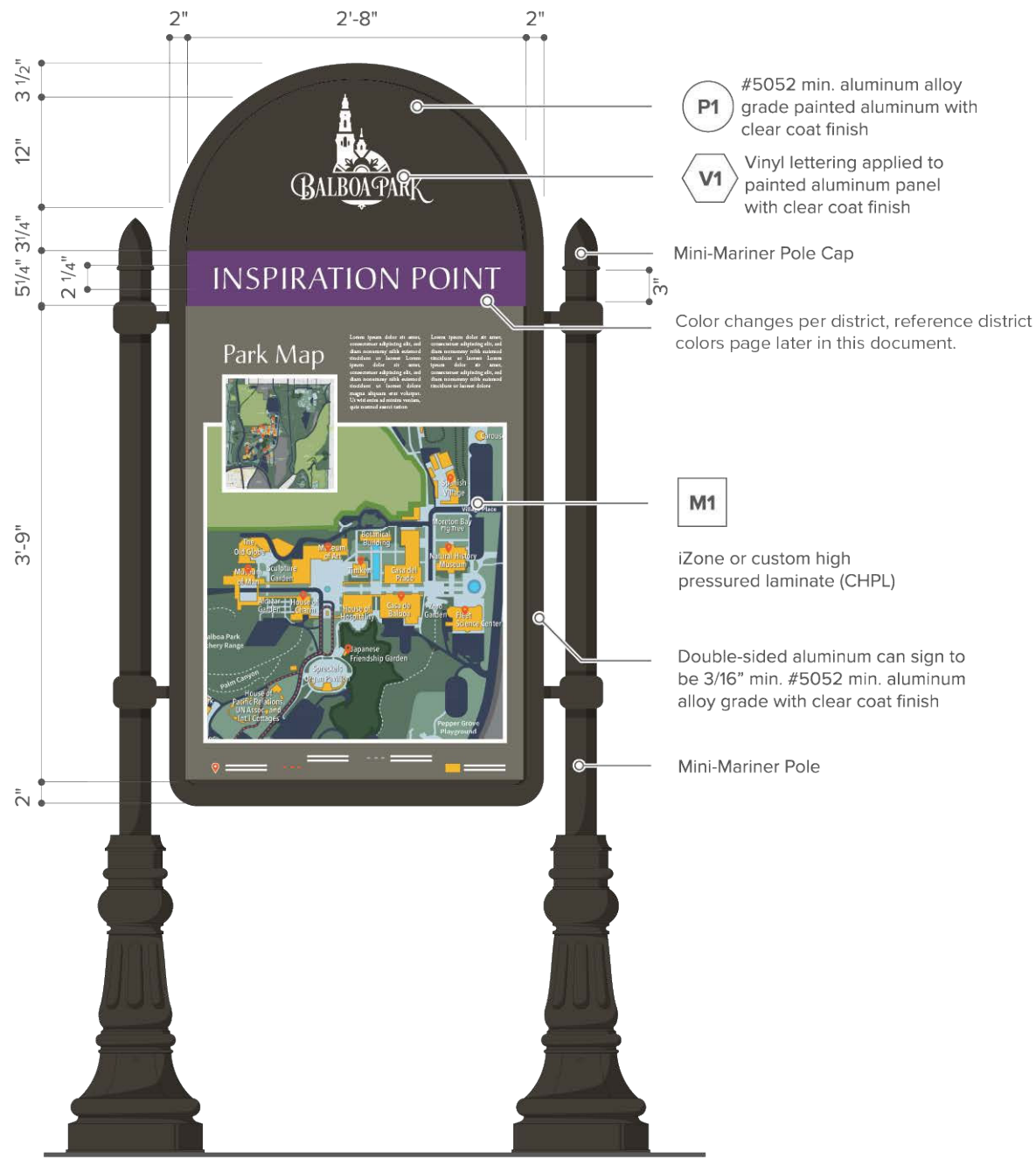

rsmdesign

160 Cabrillo  
San Clemente  
CA 2672  
949.492.9479

rsmdesign.com

**PACKAGE NOTES**  
All drawings and written materials appearing herein constitute original and unpublished work of RSM Design Inc. and may not be used or disclosed without written consent of RSM Design Inc.

All drawings must comply with specifications noted at the beginning of this package.

**PLEASE NOTE**  
All images used within this document are for internal use only. RSM Design does not have the copyrights for the various images used and therefore are not to be published or shared.

PROJECT : Balboa Park  
PACKAGE: Design Development

REVISIONS:      DATE:

1 Sign Details and Notes  
Scale : 3/4"=1'

Sign to be 3 " thick and manufactured of painted aluminum with a 60° arch top and 1 -1/2 " radius bottom corners.

A5 PEDESTRIAN DIRECTIONAL



rsmdesign

160 Cabrillo  
San Clemente  
CA 2672  
949.492.9479

rsmdesign.com

PACKAGE NOTES  
All drawings and written materials appearing herein constitute original and unpublished work of RSM Design Inc. and may not be used or disclosed without written consent of RSM Design Inc.

All drawings must comply with specifications noted at the beginning of this package.

PLEASE NOTE  
All images used within this document are for internal use only. RSM Design does not have the copyrights for the various images used and therefore are not to be published or shared.

PROJECT : Balboa Park  
PACKAGE: Design Development

REVISIONS:      DATE:



A5 PEDESTRIAN DIRECTIONAL



rsmdesign

160 Cabrillo  
San Clemente  
CA 2672  
949.492.9479

rsmdesign.com

PACKAGE NOTES  
All drawings and written materials appearing herein constitute original and unpublished work of RSM Design Inc. and may not be used or disclosed without written consent of RSM Design Inc.

All drawings must comply with specifications noted at the beginning of this package.

PLEASE NOTE  
All images used within this document are for internal use only. RSM Design does not have the copyrights for the various images used and therefore are not to be published or shared.

PROJECT : Balboa Park  
PACKAGE: Design Development

REVISIONS:      DATE:

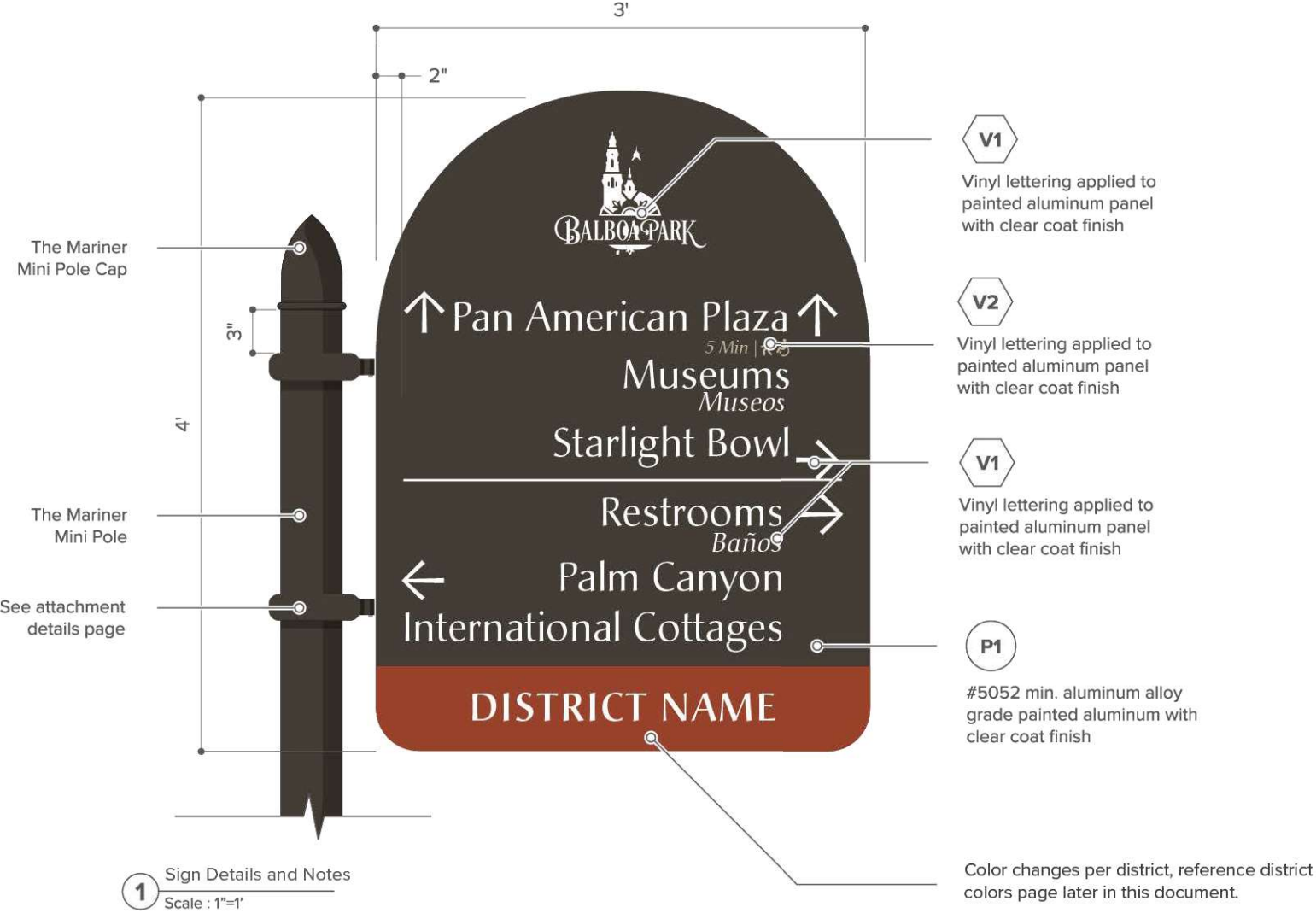

Sign to be 3 " thick and manufactured of painted aluminum with a 60° arch top and 1 -1/2 " radius bottom corners.

## A6 HIGH SPEED VEHICULAR DIRECTIONAL

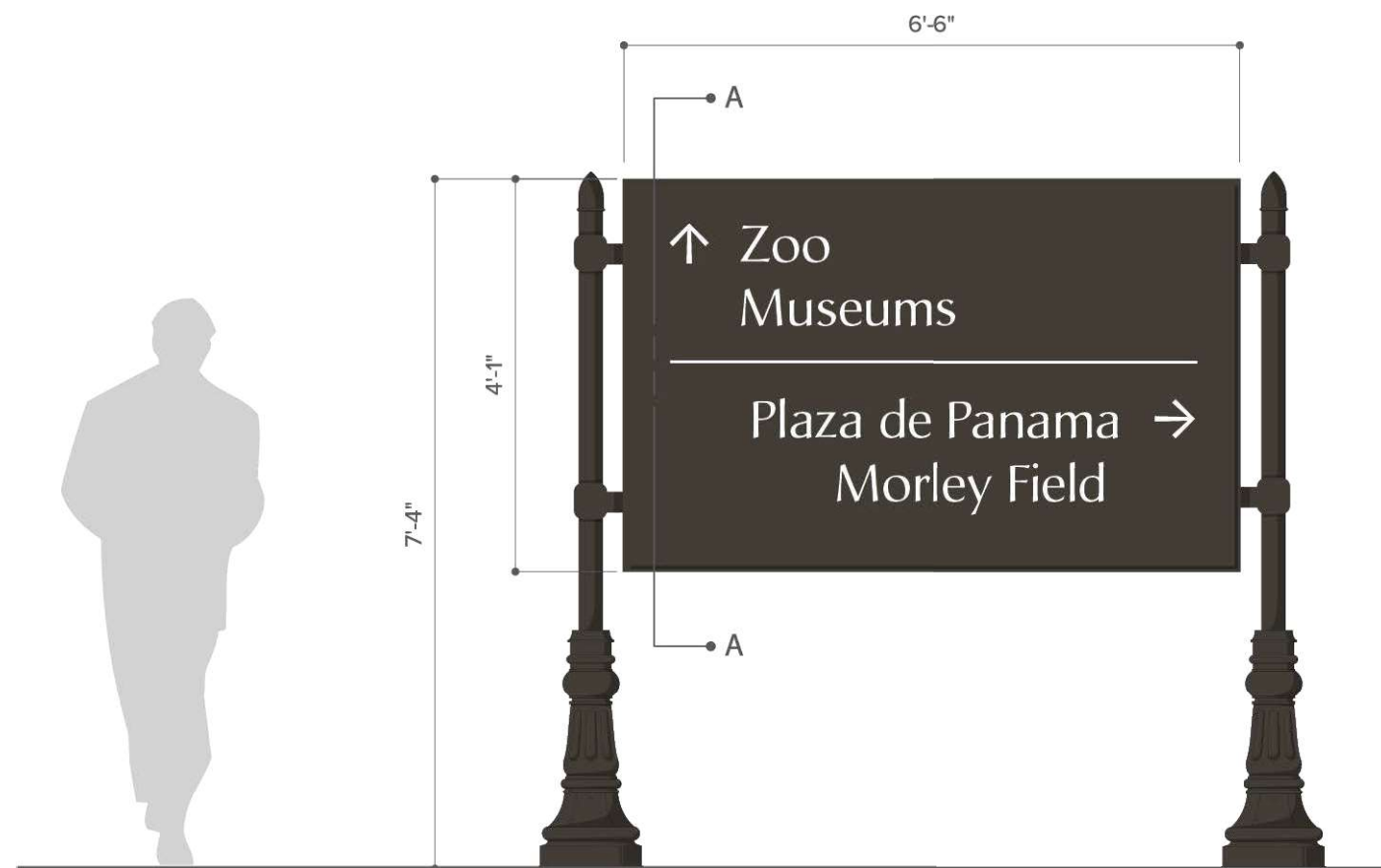

1 Pole and Sign Dimensions  
Scale : 1/2"=1'

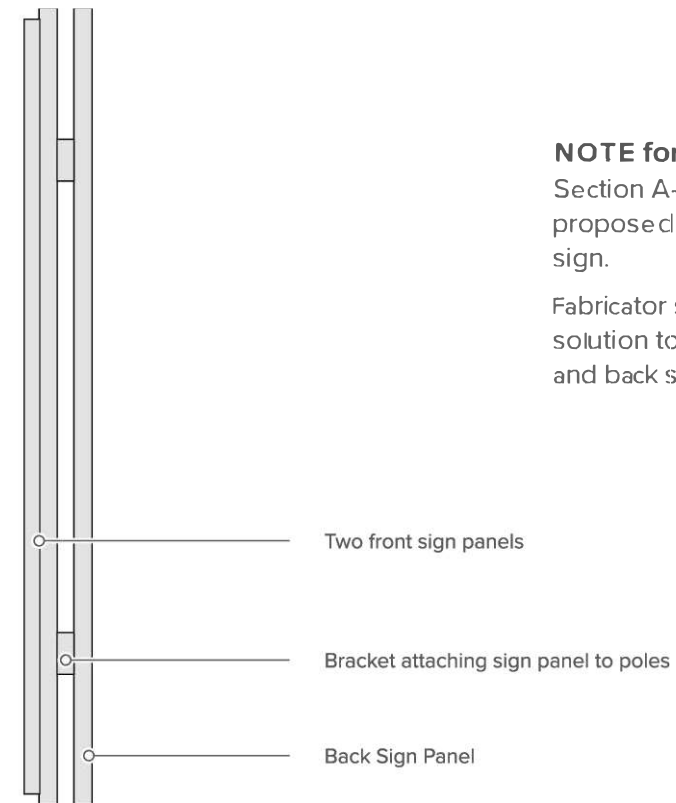

A Section A-A: Proposed Attachment Method  
NTS

**NOTE for Figure A**

Section A-A represents designer's proposed attachment method for A6 sign.

Fabricator shall recommend alternative solution to avoid the gap between front and back sign panels.

**rsm**design

160 Cabrillo  
San Clemente  
CA 92672  
949.492.9479

rsmdesign.com

**PACKAGE NOTES**

All drawings and written materials appearing herein constitute original and unpublished work of RSM Design Inc. and may not be used or disclosed without written consent of RSM Design Inc.

All drawings must comply with specifications noted at the beginning of this package.

**PLEASE NOTE**

All images used within this document are for internal use only. RSM Design does not have the copyrights for the various images used and therefore are not to be published or shared.

PROJECT : Balboa Park  
PACKAGE: Design Development

REVISIONS:      DATE:



rsmdesign

160 Cabrillo  
San Clemente  
CA 2672  
949.492.9479

rsmdesign.com

PACKAGE NOTES  
All drawings and written  
materials appearing herein  
constitute original and  
unpublished work of RSM Design  
Inc. and may not be used or  
disclosed without written  
consent of RSM Design Inc.

All drawings must comply  
with specifications noted at the  
beginning of this package.

PLEASE NOTE  
All images used within this  
document are for internal  
use only. RSM Design does  
not have the copyrights for  
the various images used and  
therefore are not to be  
published or shared.

PROJECT : Balboa Park  
PACKAGE: Design Development

REVISIONS:      DATE:

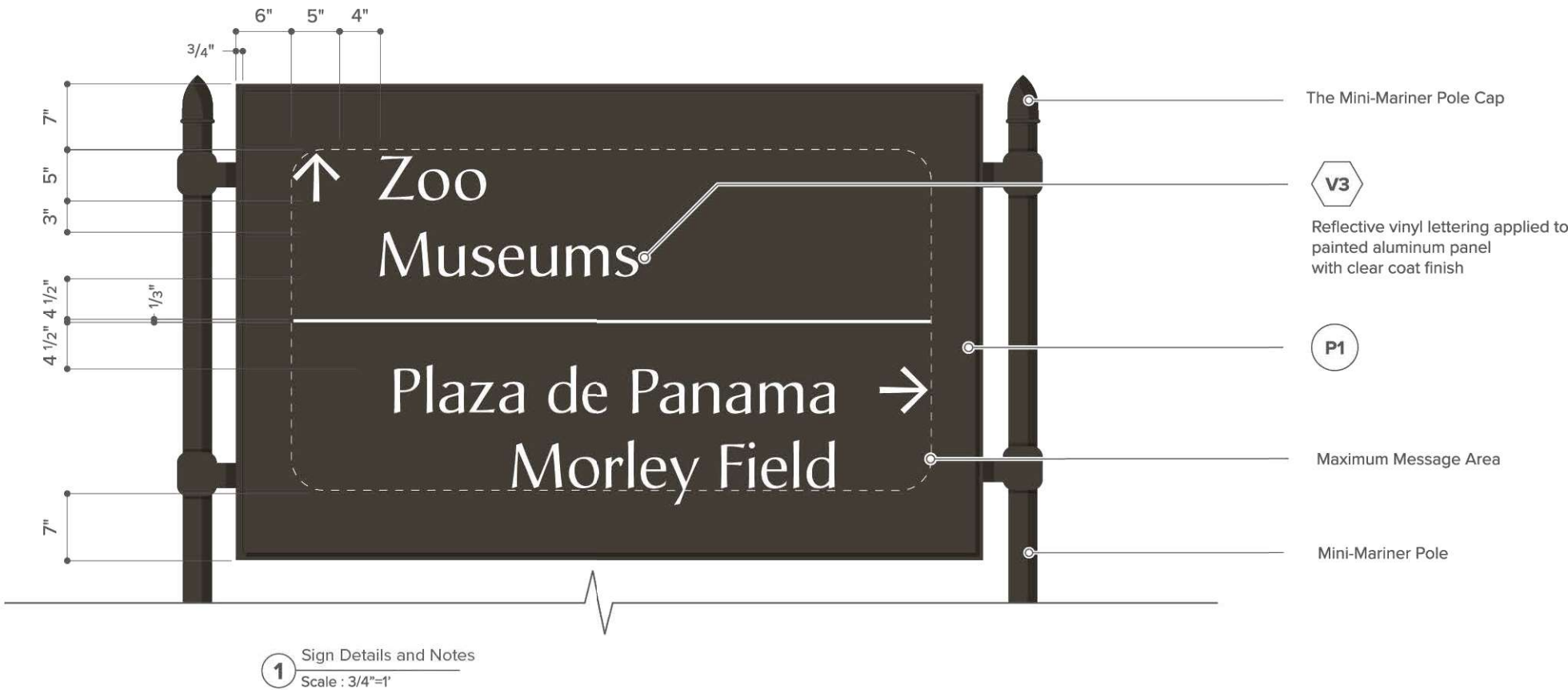



SIGNTYPE

# A13 BALBOA PARK IDENTITY



rsmdesign

160 Cabrillo  
San Clemente  
CA 2672  
949.492.9479

rsmdesign.com

PACKAGE NOTES  
All drawings and written materials appearing herein constitute original and unpublished work of RSM Design Inc. and may not be used or disclosed without written consent of RSM Design Inc.

All drawings must comply with specifications noted at the beginning of this package.

PLEASE NOTE  
All images used within this document are for internal use only. RSM Design does not have the copyrights for the various images used and therefore are not to be published or shared.

PROJECT : Balboa Park  
PACKAGE: Design Development

REVISIONS:      DATE:



1 Pole and Sign Dimensions  
Scale : 1/2"=1'



2 Sign Details and Notes  
Scale : 1"=1'

Sign to be 3 " thick and manufactured of painted aluminum with a 60° arch top and 1 -1/2 " radius bottom corners.



02

ADDITIONAL  
GUIDELINES

rsmdesign

160 Cabrillo  
San Clemente  
CA 2672  
949.492.9479

rsmdesign.com

PACKAGE NOTES  
All drawings and written  
materials appearing herein  
constitute original and  
unpublished work of RSM Design  
Inc. and may not be used or  
disclosed without written  
consent of RSM Design Inc.

All drawings must comply  
with specifications noted at the  
beginning of this package.

PLEASE NOTE  
All images used within this  
document are for internal  
use only. RSM Design does  
not have the copyrights for  
the various images used and  
therefore are not to be  
published or shared.

PROJECT: Balboa Park  
PACKAGE: Design Development

REVISIONS:	DATE:



DESIGN CHARACTER

# POLE STANDARDS

The areas designated as a historical landmark will incorporate pole standards reflecting the pole design used in the park during the exposition periods. The signs however will remain true to the park sign guidelines.

## The Prado

The pole standards for the Prado shall be compatible with the historical architecture of the 1915 Exposition. The style is Capistrano, manufactured by Spring City Lighting. The pole standard color for the Prado is a bronze green, Frazee #6125N based on writings of Carlton Monroe Winslow - Architecture & Gardens-San Diego Exposition 1915.

Poles will be 3" and 5" diameter aluminum tubing. Pole wall thickness to be 1/8" min. for the 3" pole, and 3/16" min. for the 5" pole. Pole bracket and footing to be engineered by fabricator. Depending on pole height and loading, anchor bolts may change. Poles to be painted with three (3) color coats of polyurethane.



MARINER



MINI-MARINER



CAPISTRANO

## Sign Pole Color Prado

The sign standards in the Prado area of the park, which include the Capistrano pole, base, brackets, horizontal pipe & the cap will be Frazee Custom Color CZ-12-2935.

## Overall

Bases are the Mariner and Mini-Mariner manufactured by Spring City Lighting. Bases to be anchored to pole/ base footing as per manufacturer's specifications. Bases to be painted with three (3) color coats of polyurethane.

Fabricator is responsible for isolating dissimilar materials to prevent electrolysis.

## Sign Pole Color Overall

The color for the sign standards, which include the Mariner and Mini-Mariner pole, base, brackets, horizontal pipe & the cap will be Matthews Paint MP201189 Corinthian Bronze Metallic.



rsmdesign

160 Cabrillo  
San Clemente  
CA 2672  
949.492.9479

rsmdesign.com

PACKAGE NOTES  
All drawings and written materials appearing herein constitute original and unpublished work of RSM Design Inc. and may not be used or disclosed without written consent of RSM Design Inc.

All drawings must comply with specifications noted at the beginning of this package.

PLEASE NOTE  
All images used within this document are for internal use only. RSM Design does not have the copyrights for the various images used and therefore are not to be published or shared.

PROJECT: Balboa Park  
PACKAGE: Design Development

REVISIONS:      DATE:



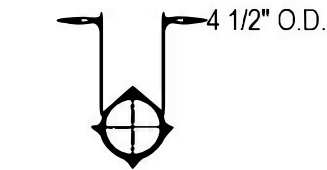
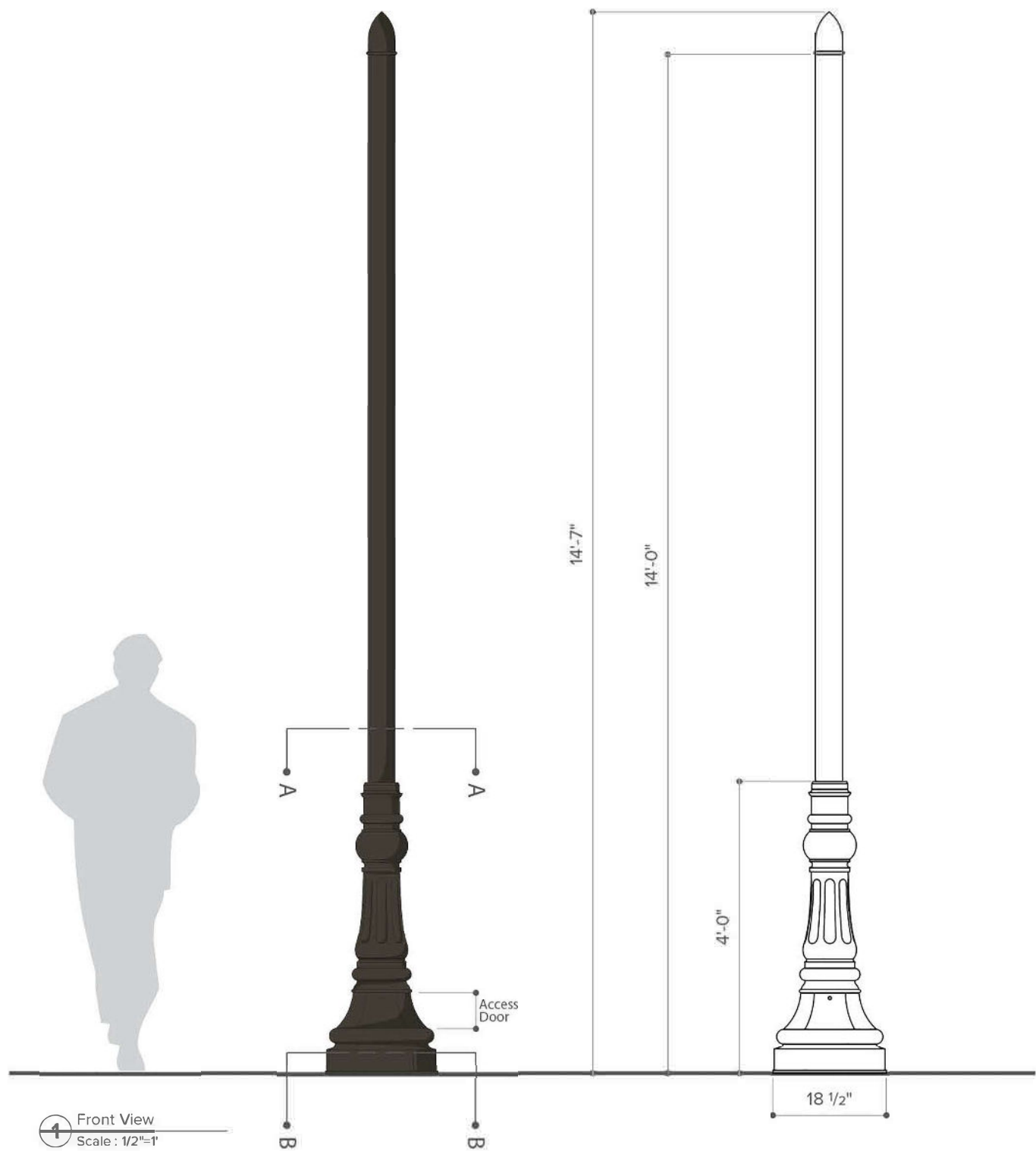

**SECTION A-A**  
4 1/2" O.D.  
SMOOTH ALUMINUM  
N.T.S.

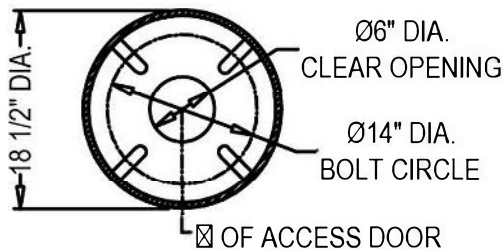

**SECTION B-B**  
BASE PLATE DETAIL

**STYLE**

Mariner

**HEIGHT**

14'-0"

**BASE**

18 1/2" Diameter

**MATERIAL**

Shaft - 4" SCH-40 Aluminum  
Pipe (4 1/2" OD) 6061-T6  
Base - 1 Piece, Heavy Wall Cast  
Aluminum Alloy A.N.S.I. 356, PER  
A.S.T.M. B26-95

**FINISH**

Powder Coat - To match Corinthian Bronze Metallic

**ACCESS DOOR**

Located in base secured with tamper proof hex socket  
security machine screws

**GROUND STUD PROVISIONS**

Drill and tap inside wall of base opposite access door to  
accommodate a 1/4"-20 ground stud (stud by others)

**ANCHOR BOLTS**

(4) 3/4" X 24" + 3" hook (fully galvanized with 1  
galvanized nut and 1 galvanized washer per bolt)

**BOLT PROJECTION**

3" required

**CATALOG NUMBER**

Pole - APSMRN-18-14.00-S45-CU  
Pole Finial - AFNBL-4.0-07.00-CU

**SPRING CITY ELECTRICAL MFG. CO.**

Hall and Main Streets - P.O. Box 19 -  
Spring City, PA 19475  
Phone (610) 948-4000  
Fax (610) 948-5577  
www.springcity.com

**DESCRIPTION**

The 14'0" Mariner



**rsmdesign**

160 Cabrillo  
San Clemente  
CA 2672  
949.492.9479

rsmdesign.com

**PACKAGE NOTES**

All drawings and written  
materials appearing herein  
constitute original and  
unpublished work of RSM Design  
Inc. and may not be used or  
disclosed without written  
consent of RSM Design Inc.

All drawings must comply  
with specifications noted at the  
beginning of this package.

**PLEASE NOTE**

All images used within this  
document are for internal  
use only. RSM Design does  
not have the copyrights for  
the various images used and  
therefore are not to be  
published or shared.

PROJECT : Balboa Park  
PACKAGE: Design Development

REVISIONS:      DATE:

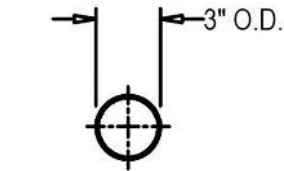
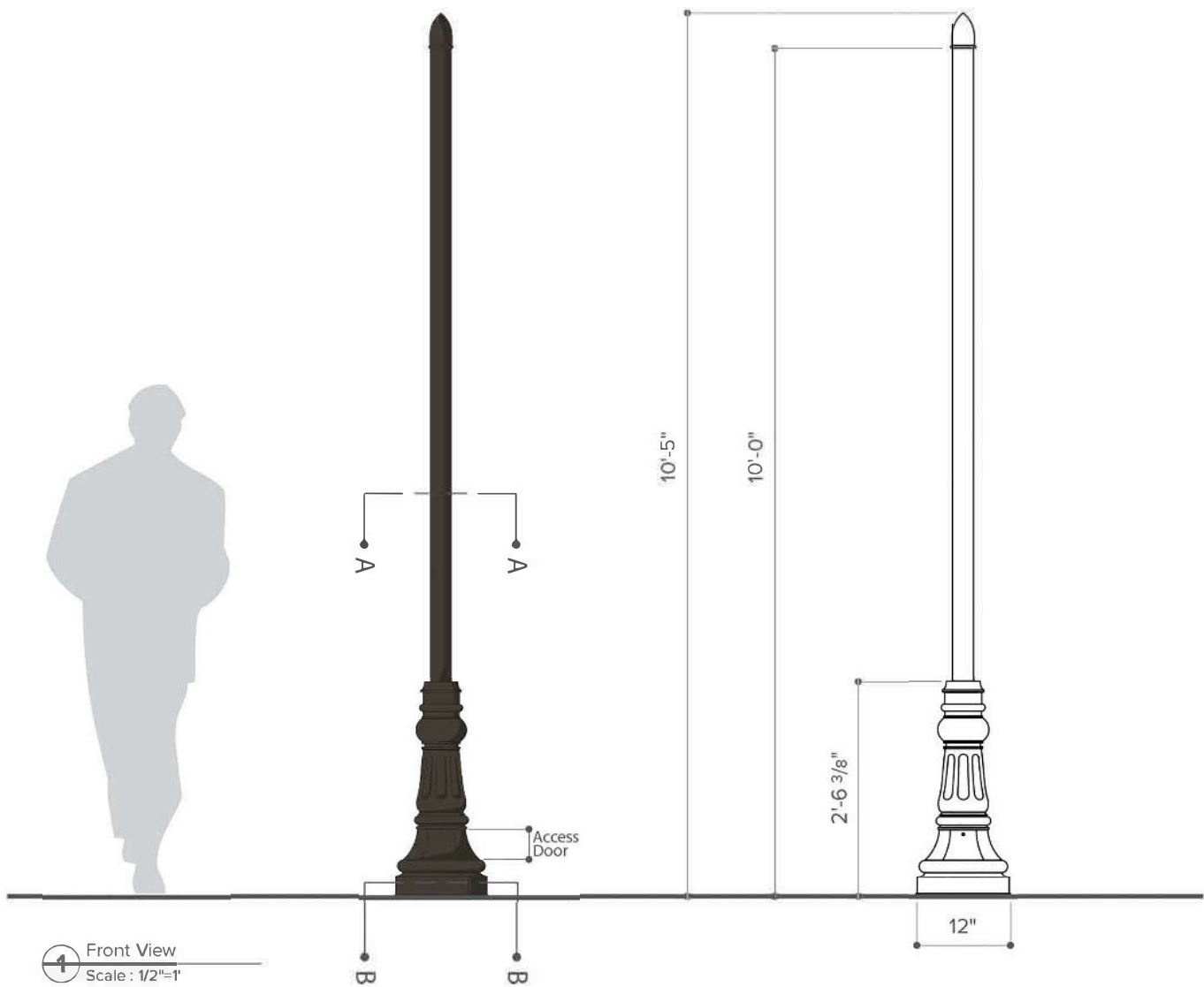
SECTION A-A

3" O.D.  
SMOOTH ALUMINUM  
N.T.S.

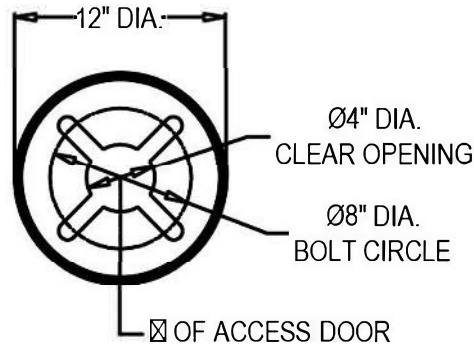

SECTION B-B

BASE PLATE DETAIL  
N.T.S.

**STYLE**  
Mini-Mariner

**HEIGHT**  
Varies by Sign Type: 7', 10', or 12'

**BASE**  
12" Diameter

**MATERIAL**  
Shaft - 2 1/2" SCH-40 Aluminum  
Pipe (3" OD) 6061-T6  
Base - Cast Aluminum Alloy A.N.S.I. 356, PER A.S.T.M. B26-95

**FINISH**  
Powder Coat - To match Corinthian Bronze Metallic

**ACCESS DOOR**  
Located in base secured with tamper proof hex socket security machine screws

**GROUND STUD PROVISIONS**  
Drill and tap inside base opposite access door to accommodate a 1/4"-20 ground stud (stud by others)

**ANCHOR BOLTS**  
(4) 3/4" X 17" + 3" hook (fully galvanized with 1 galvanized nut and 1 galvanized washer per bolt)

**BOLT PROJECTION**  
3" required

**CATALOG NUMBER**  
12' Pole - APSMNM-12-12.00-S30-CU  
10' Pole - APSMNM-12-10.00-S30-CU  
7' Pole - APSMNM-12-07.00-S30-CU

Pole Finial - AFNBLB-3.0-05.00-CU

**SPRING CITY ELECTRICAL MFG. CO.**  
Hall and Main Streets - P.O. Box 19 -  
Spring City, PA 19475  
Phone (610) 948-4000  
Fax (610) 948-5577  
www.springcity.com

**DESCRIPTION**  
The 10'0" Mini-Mariner with Tram Stop Sign



rsmdesign

160 Cabrillo  
San Clemente  
CA 2672  
949.492.9479

rsmdesign.com

**PACKAGE NOTES**  
All drawings and written materials appearing herein constitute original and unpublished work of RSM Design Inc. and may not be used or disclosed without written consent of RSM Design Inc.

All drawings must comply with specifications noted at the beginning of this package.

**PLEASE NOTE**  
All images used within this document are for internal use only. RSM Design does not have the copyrights for the various images used and therefore are not to be published or shared.

PROJECT : Balboa Park  
PACKAGE: Design Development

REVISIONS:      DATE:

1	
2	
3	
4	
5	
6	
7	
8	
9	
10	

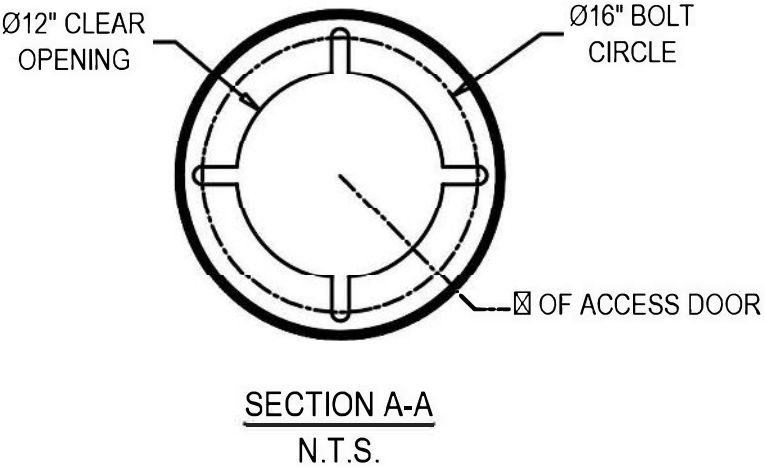
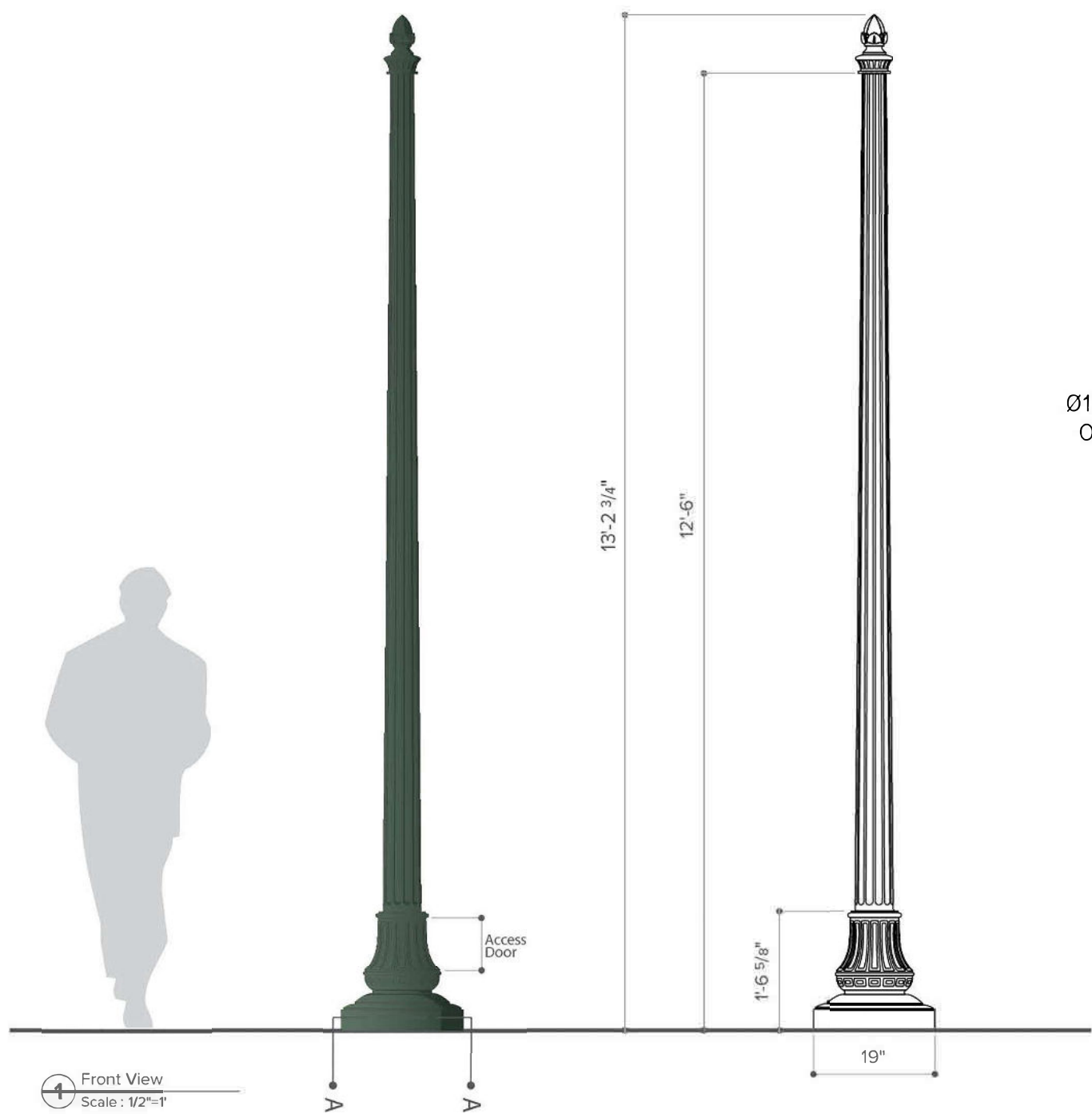

**STYLE**  
Capistrano

**HEIGHT**  
Varies by Sign Type: 7' or 12'-6"

**BASE**  
19" Diameter

**MATERIAL**  
Cast Aluminum Alloy ANSI 356 Per A.S.T.M. B26-95

**FINISH**  
Powder Coat - To match Frazee Custom Color CZ-12-2935

**ACCESS DOOR**  
Located in base secured with tamper proof hex socket security machine screws

**GROUND STUD PROVISIONS**  
Drill and tap inside wall of base opposite access door to accommodate a 1/4"-20 ground stud (stud by others)

**ANCHOR BOLTS**  
(4) 3/4" X 24" + 3" hook (fully galvanized with 1 galvanized nut and 1 galvanized washer per bolt)

**BOLT PROJECTION**  
3" required

**TENON**  
2 7/8" DIA. X 2" High (To Accept Finial)

**CATALOG NUMBER**  
12'-6" Shaft - APSCPS-19-12.50-2F-TN2.88/2.00-CU  
7' Shaft - APSCPS-19-12.50-2F-TN2.88/2.00-CU

Pole Finial - AFNWSO-04-08.75-CU

**SPRING CITY ELECTRICAL MFG. CO.**  
Hall and Main Streets - P.O. Box 19 -  
Spring City, PA 19475  
Phone (610) 948-4000  
Fax (610) 948-5577  
www.springcity.com

**DESCRIPTION**  
The 12'6" Capistrano Aluminum Post with Tram Stop Sign



**rsmdesign**

160 Cabrillo  
San Clemente  
CA 2672  
949.492.9479

rsmdesign.com

**PACKAGE NOTES**  
All drawings and written materials appearing herein constitute original and unpublished work of RSM Design Inc. and may not be used or disclosed without written consent of RSM Design Inc.

All drawings must comply with specifications noted at the beginning of this package.

**PLEASE NOTE**  
All images used within this document are for internal use only. RSM Design does not have the copyrights for the various images used and therefore are not to be published or shared.

PROJECT: Balboa Park  
PACKAGE: Design Development

REVISIONS: DATE:

1	
2	
3	
4	
5	
6	
7	
8	
9	
10	
11	
12	

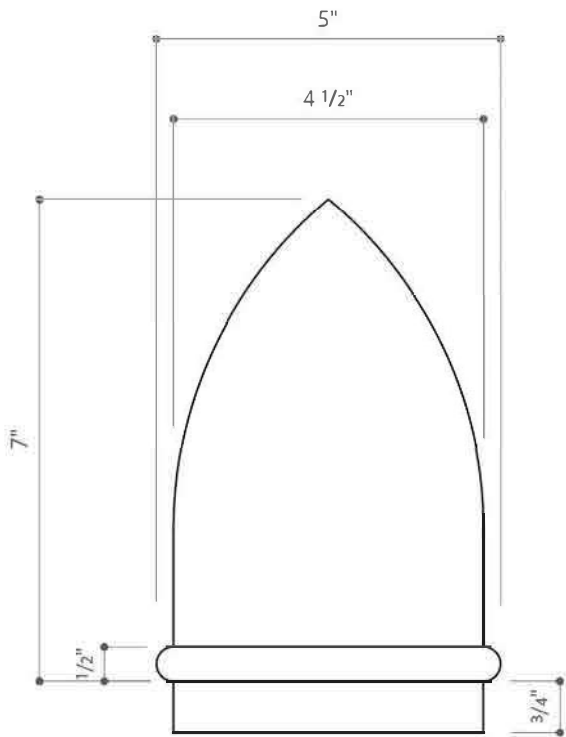

**STYLE**  
Mariner Pole Cap

**HEIGHT**  
7"

**BASE**  
5" Diameter

**MATERIAL**  
Cast Aluminum Alloy 356 Per A.S.T.M. B26-95

**FINISH**  
Powder Coat - To match Corinthian Bronze Metallic

**CATALOG NUMBER**  
AFNBLB-4.5-07.00-CU

**SPRING CITY ELECTRICAL MFG. CO.**  
Hall and Main Streets - P.O. Box 19 - Spring City, PA 19475  
PHONE (610) 948-4000  
FAX (610) 948-5577  
www.springcity.com

**DESCRIPTION**  
The Mariner Pole Cap

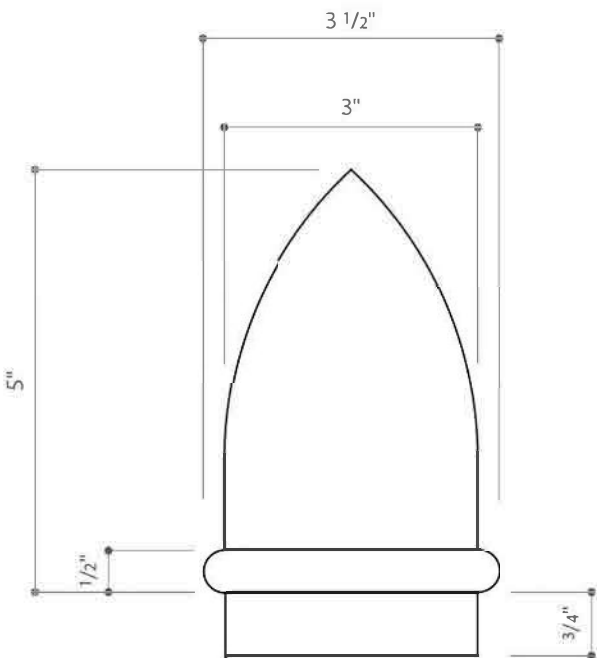

**STYLE**  
Mini-Mariner Pole Cap

**HEIGHT**  
5"

**BASE**  
5 1/2" Diameter

**MATERIAL**  
Cast Aluminum Alloy A.N.S.I. 356 Per A.S.T.M. B26-95

**FINISH**  
Powder Coat - To match Corinthian Bronze Metallic

**CATALOG NUMBER**  
AFNBLB-3.0-05.00-CU

**SPRING CITY ELECTRICAL MFG. CO.**  
Hall and Main Streets - P.O. Box 19 - Spring City, PA 19475  
PHONE (610) 948-4000  
FAX (610) 948-5577  
www.springcity.com

**DESCRIPTION**  
The Mini-Mariner Pole Cap

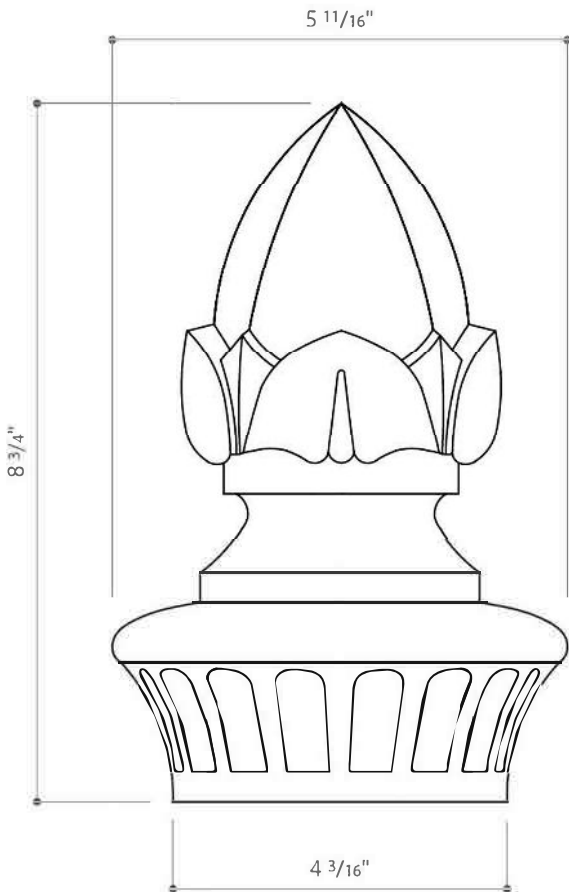

**STYLE**  
Capistrano Pole Cap

**HEIGHT**  
8 3/4"

**BASE**  
5 11/16" Diameter

**MATERIAL**  
Cast Aluminum Alloy A.N.S.I. 356 Per A.S.T.M. B26-95

**FINISH**  
Powder Coat - To match Frazee Cuton Color CZ-12-2935

**CATALOG NUMBER**  
AFNWSO-04-08.75-CU

**SPRING CITY ELECTRICAL MFG. CO.**  
Hall and Main Streets - P.O. Box 19 - Spring City, PA 19475  
PHONE (610) 948-4000  
FAX (610) 948-5577  
www.springcity.com

**DESCRIPTION**  
The Capistrano Pole Cap



**rsm**design

160 Cabrillo  
San Clemente  
CA 2672  
949.492.9479

rsmdesign.com

**PACKAGE NOTES**  
All drawings and written materials appearing herein constitute original and unpublished work of RSM Design Inc. and may not be used or disclosed without written consent of RSM Design Inc.

All drawings must comply with specifications noted at the beginning of this package.

**PLEASE NOTE**  
All images used within this document are for internal use only. RSM Design does not have the copyrights for the various images used and therefore are not to be published or shared.

PROJECT : Balboa Park  
PACKAGE: Design Development

REVISIONS:      DATE:

# ATTACHMENT DETAILS

Existing attachment details below. Sign  
fabricator to verify in field

## EXISTING ATTACHMENT DETAIL TO BE USED ON SIGN TYPES A3, A4, A5, & A6

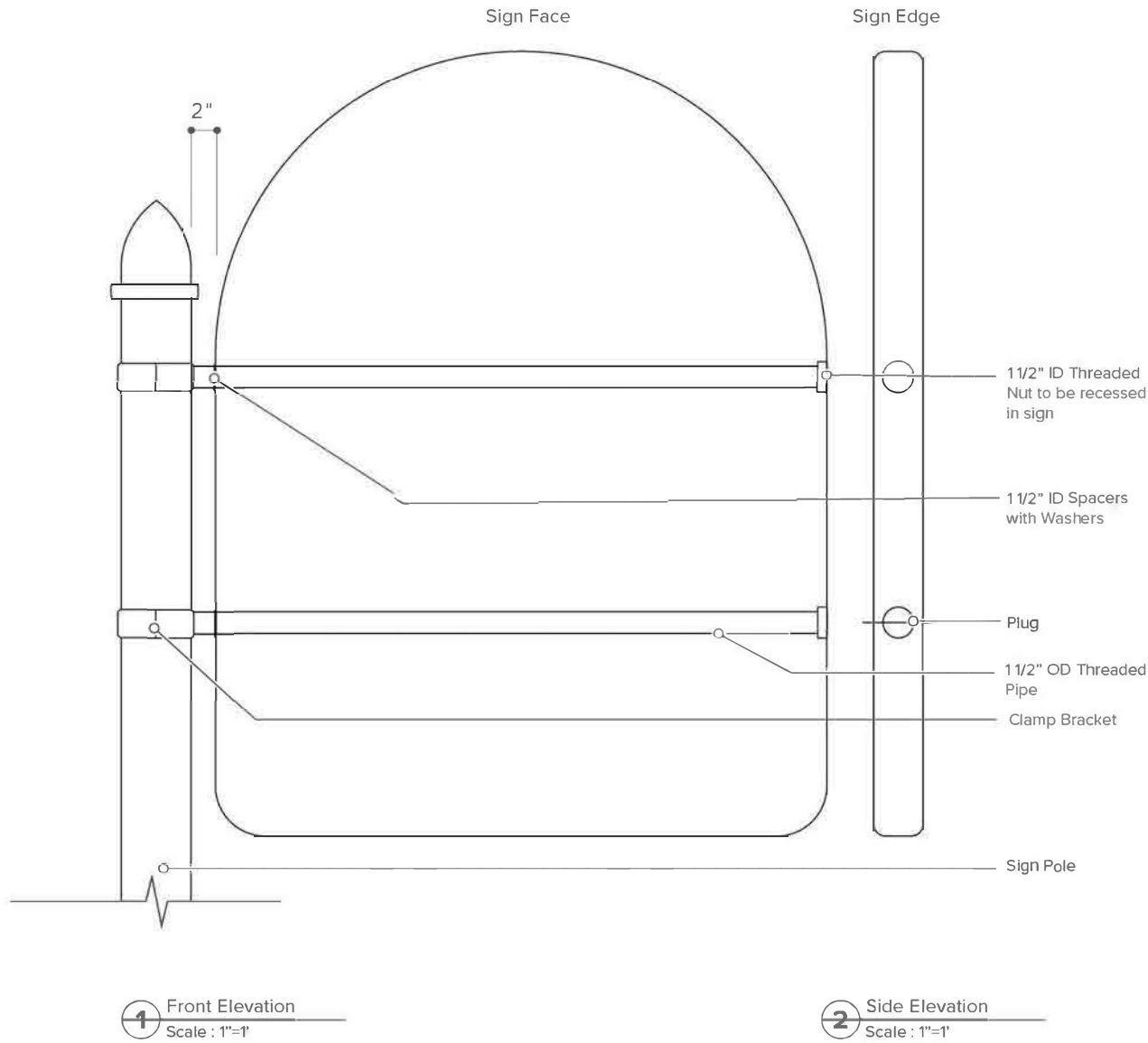

1	
2	
3	
4	
5	
6	
7	
8	



# ATTACHMENT DETAILS

Existing attachment details on the left. RSM recommended update for all new signs shown on the right. Sign fabricator to verify in field

## EXISTING ATTACHMENT DETAIL

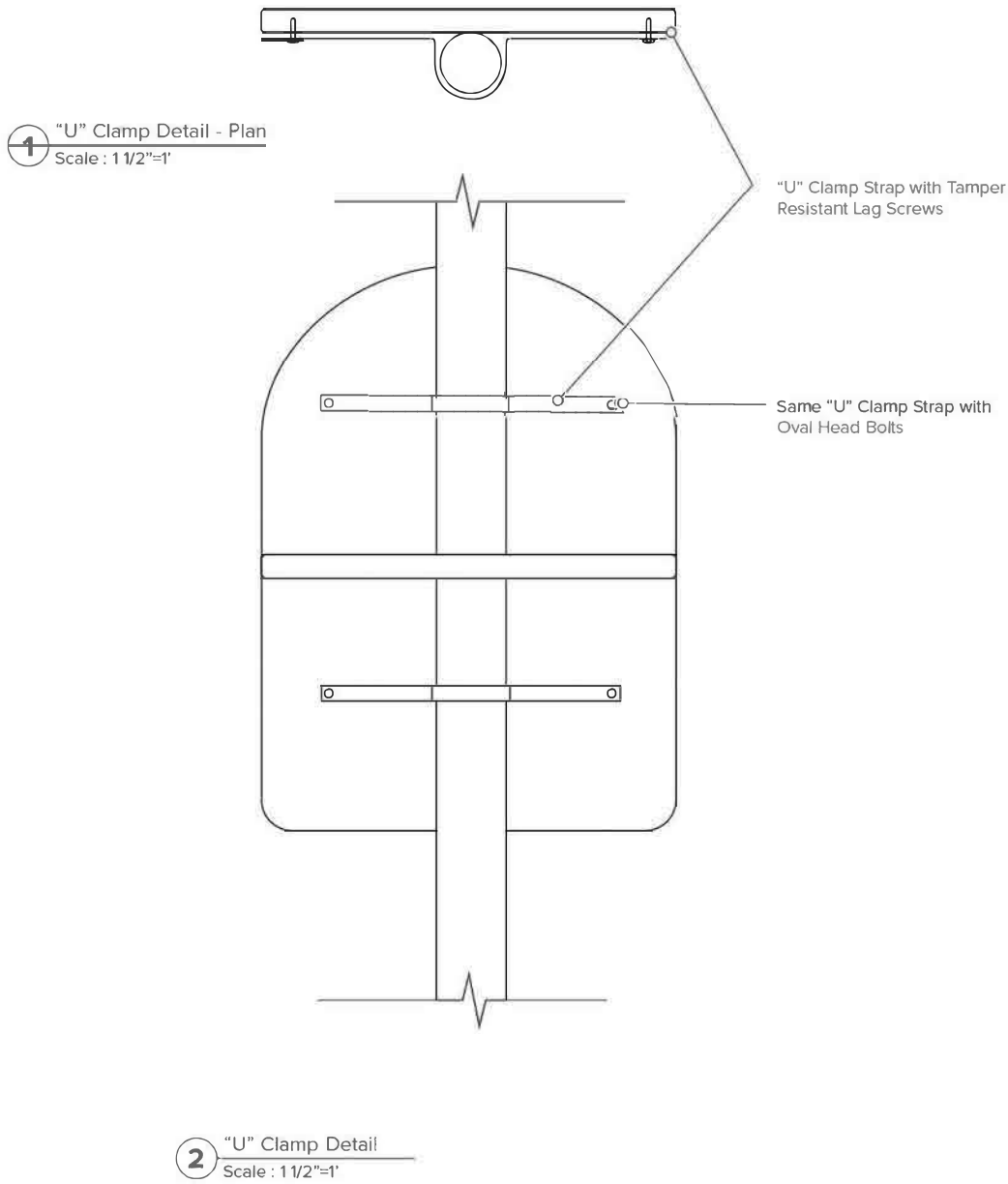

## RECOMMENDED ATTACHMENT DETAIL TWO THINNER PLATES INSTEAD OF ONE THAT IS THICK TO BE USED ON SIGN TYPES A1, A7, A9

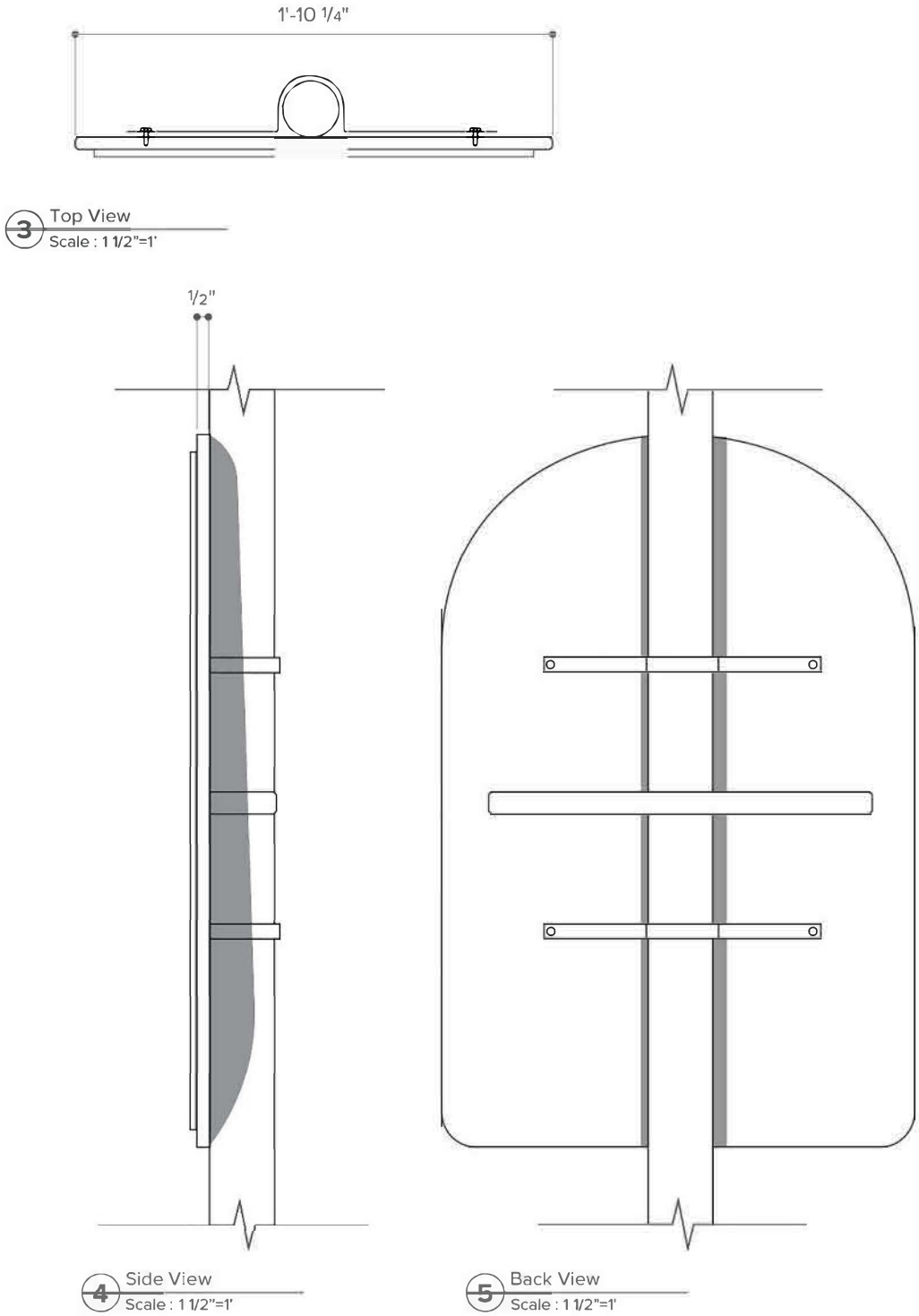

rsmdesign

160 Cabrillo  
San Clemente  
CA 2672  
949.492.9479

rsmdesign.com

**PACKAGE NOTES**  
All drawings and written materials appearing herein constitute original and unpublished work of RSM Design Inc. and may not be used or disclosed without written consent of RSM Design Inc.

All drawings must comply with specifications noted at the beginning of this package.

**PLEASE NOTE**  
All images used within this document are for internal use only. RSM Design does not have the copyrights for the various images used and therefore are not to be published or shared.

PROJECT : Balboa Park  
PACKAGE: Design Development

REVISIONS: DATE:

DESIGN CHARACTER

# PAINT & MATERIALS

The following illustrates the proposed paints and materials. Please Note all final colors and materials to be approved by client team prior to fabrication.

## PAINTS

All paints to have Satin Finish unless otherwise specified. All painted surfaces are to be on aluminum.

P1

Matthews  
MP20189 Corinthian  
Bronze Metallic

P2

Matthews  
MP16211  
Gordal Olive

P3

Matthews  
MP11228  
Great Falls

P4

Matthews  
MP12385  
Clay Beige

P5

Matthews  
MP01126  
Davies Crest Reda

P6

Matthews  
MP03697  
Indigo

P7

Matthews  
MP14722  
Purple Gallinule

P8

Matthews  
MP05041  
Roseate Spoonbill

P9

Matthews  
MP02643  
Amulet Blue

P10

Matthews  
MP03395  
Talavera Tile

P11

Matthews  
MP12994  
Malua Mauve

P12

Matthews  
MP02795  
Spice Trader

P13

Matthews  
MP12718  
Unicor Brown

P14

Matthews  
MP32156  
Black Magic

P15

Matthews  
MP20158  
Statuary Bronze Metallic

P16

Frazee  
Custom Color  
CZ-12-2935

## MATERIALS

All materials to be provided as 8" x 8" sample or as part of a mock-up for approval.

M1

iZone  
TBD

## VINYL

All materials to be provided as 8" x 8" sample or as part of a mock-up for approval.

V1

Avery Dennison  
SC 900-101-0  
White

V2

Avery Dennison  
SC 900-965-0  
Sandstone

V3

Avery Dennison  
SC ?????????  
Reflective White

Fabricator shall submit 2 (two) sets of sample and/or prototypes of each material, paint and vinyl call out listed on this sheet that will be used in this project, minimum size 8"x 8" in size. All paint spray outs must be on aluminum.

Samples must be submitted to client team in a time frame allowable for review of material, color and aesthetic compatibility to any existing adjacent materials.

Client team will review the samples and will keep one set as control samples throughout the fabrication process. The client will send the other set back to the fabricator.

If a color or material is not approved, the Fabricator must re-submit a new sample until it is approved by the team.



rsmdesign

160 Cabrillo  
San Clemente  
CA 2672  
949.492.9479

rsmdesign.com

**PACKAGE NOTES**  
All drawings and written materials appearing herein constitute original and unpublished work of RSM Design Inc. and may not be used or disclosed without written consent of RSM Design Inc.

All drawings must comply with specifications noted at the beginning of this package.

**PLEASE NOTE**  
All images used within this document are for internal use only. RSM Design does not have the copyrights for the various images used and therefore are not to be published or shared.

PROJECT : Balboa Park	
PACKAGE: Design Development	
REVISIONS:	DATE:



# SIGN LOCATIONS

The blue map points in the image to the right indicate sign locations.

Digital map with sign coordinates available [by clicking here](#)..

Final sign specifications and locations to be confirmed by client team prior to fabrication.

